



COMMONWEALTH OF KENTUCKY
TRANSPORTATION CABINET

www.transportation.ky.gov/

Andy Beshear
GOVERNOR

Jim Gray
SECRETARY

August 19, 2020

CALL NO. 201
CONTRACT ID NO. 201024
ADDENDUM # 2

Subject: HARDIN COUNTY, 047GR20D024-NHPP-HSIP
Letting August 21, 2020

- (1) Revised - Special Note for Geocomposite Reinforcement for Asphalt -
Page 37 of 198
- (2) Revised - Material Summary - Pages 138-145 of 198
- (3) Revised - Proposal Bid Items - Pages 194-198 of 198
- (4) Added - Special Note for Lane Separator Curb - Pages 1-2 of 2
- (5) Revised - Plan Sheets - R2P, R2Q, R29, X66, and X67

Proposal revisions are available at <http://transportation.ky.gov/Construction-Procurement/>.

If you have any questions, please contact us at 502-564-3500.

Sincerely,

A handwritten signature in black ink that reads "Rachel Mills".

Rachel Mills, P.E.
Director
Division of Construction Procurement

RM:mr
Enclosures

August 14, 2020

SPECIAL NOTE FOR GEOCOMPOSITE REINFORCEMENT FOR ASPHALT

This Special Note will apply where indicated on the plans or in the proposal. Section references herein are to the Department’s Current Standard Specifications for Road and Bridge Construction.

1.0 DESCRIPTION. This specification covers geocomposites used as an interlayer in asphalt pavements.

2.0 MATERIALS AND EQUIPMENT.

2.1 Geocomposite. The geocomposite shall consist of a geogrid component with a non-woven geotextile (paving fabric) backing. Furnish fiberglass-reinforced or polyester geogrid coated with an elastomeric polymer. Ensure the geogrid forms a stable network such that the ribs, filaments, or yarns retain their dimensional stability, including selvages. Furnish geogrid with a non-woven paving fabric backing composed of long chain synthetic polymers that are 95 percent by weight polyolefins or polyesters.

A) Physical Requirements. Furnish the specified geogrid type conforming to the Physical Requirements Table and ASTM D 4759. Ensure that each geogrid shipment is accompanied by a manufacturer’s certification listing minimum average roll specification values (MARV) of each lot number for those properties listed in the table below. Furnish geogrid with a minimum of a non-woven geotextile backing for ease of installation.

PROPERTY	TEST METHOD	SPECIFICATION
Geogrid Tensile Strength, lb/in (min.)	ASTM D6637 Test Method A	560
Geogrid Elongation, % (max.)	ASTM D6637	< 3
Melting Point of Paving Fabric Component, °F (min.)	ASTM D 276	320
Grid Size, inch (min/max)	Calipered	0.5/1.25

B) Packaging, Shipment, and Storage. Ensure that each roll is labeled with the manufacturer’s name, product type, style number, lot number, roll number, manufactured date, roll dimensions, chemical composition, and applicable physical properties. Protect the geocomposite from direct sunlight, ultraviolet rays, flames, aggressive chemicals, mud, dirt, dust, and debris during all periods of shipment and storage. Keep geocomposite dry until installation, and do not store directly on the ground.

MATERIAL SUMMARY

CONTRACT ID: 201024

047GR20D024-NHPP-HSIP

DE047031W2024

US-31W IMPROVE SAFETY AND MOBILITY AND, REDUCE CONGESTION ON US-31W FROM US-31WB TO KY 447 ASPHALT REHAB WITH GRADE & DRAIN, A DISTANCE OF 1.95 MILES.

Project Line No	Bid Code	DESCRIPTION	Quantity	Unit
0005	00003	CRUSHED STONE BASE	486.00	TON
0010	00214	CL3 ASPH BASE 1.00D PG64-22	319.00	TON
0015	00216	CL3 ASPH BASE 1.00D PG76-22	319.00	TON
0020	00336	CL3 ASPH SURF 0.38A PG76-22	204.00	TON
0025	24780EC	INTELLIGENT COMPACTION FOR AGGREGATE	486.00	TON
0030	24781EC	INTELLIGENT COMPACTION FOR ASPHALT - (REVISED: 8-19-20)	842.00	TON
0035	24785EC	FIBER REINFORCEMENT FOR HMA	523.00	TON
0040	24891EC	PAVE MOUNT INFRARED TEMP EQUIPMENT	54,333.00	SF
0045	24970EC	ASPHALT MATERIAL FOR TACK NON-TRACKING	2.00	TON
0050	01810	STANDARD CURB AND GUTTER	586.00	LF
0055	01811	STANDARD CURB AND GUTTER MOD	732.00	LF
0060	01875	STANDARD HEADER CURB	43.00	LF
0065	01891	ISLAND HEADER CURB TYPE 2	452.00	LF
0070	01904	REMOVE CURB	25.00	LF
0075	01921	STANDARD BARRIER MEDIAN TYPE 4 - (REVISED: 8-19-20)	5,997.00	SQYD
0080	02091	REMOVE PAVEMENT	1,796.00	SQYD
0085	02159	TEMP DITCH	660.00	LF
0090	02160	CLEAN TEMP DITCH	330.00	LF
0095	02200	ROADWAY EXCAVATION - (REVISED: 8-19-20)	4,444.00	CUYD
0100	02203	STRUCTURE EXCAV-UNCLASSIFIED	32.00	CUYD
0105	02223	GRANULAR EMBANKMENT	14.00	CUYD
0110	02237	DITCHING	500.00	LF
0115	02429	RIGHT-OF-WAY MONUMENT TYPE 1	2.00	EACH
0120	02432	WITNESS POST	1.00	EACH
0125	02483	CHANNEL LINING CLASS II	22.00	TON
0130	02555	CONCRETE-CLASS B	14.80	CUYD
0135	02607	FABRIC-GEOTEXTILE CLASS 2 FOR PIPE	4,192.00	SQYD
0140	02611	HANDRAIL-TYPE A-1	67.00	LF
0145	02701	TEMP SILT FENCE	660.00	LF
0150	02703	SILT TRAP TYPE A	5.00	EACH
0155	02704	SILT TRAP TYPE B	5.00	EACH
0160	02705	SILT TRAP TYPE C	5.00	EACH
0165	02706	CLEAN SILT TRAP TYPE A	5.00	EACH
0170	02707	CLEAN SILT TRAP TYPE B	5.00	EACH
0175	02708	CLEAN SILT TRAP TYPE C	5.00	EACH
0180	02720	SIDEWALK-4 IN CONCRETE	368.00	SQYD
0185	02726	STAKING - 154.20	1.00	LS
0190	03262	CLEAN PIPE STRUCTURE	24.00	EACH
0195	04960	REMOVE AND REPLACE SIDEWALK	26.00	SQYD
0200	05950	EROSION CONTROL BLANKET	1,285.00	SQYD
0205	05952	TEMP MULCH	4,700.00	SQYD
0210	05953	TEMP SEEDING AND PROTECTION	3,450.00	SQYD

MATERIAL SUMMARY

Project Line No	Bid Code	DESCRIPTION	Quantity	Unit
0215	05963	INITIAL FERTILIZER	.20	TON
0220	05964	MAINTENANCE FERTILIZER	.33	TON
0225	05985	SEEDING AND PROTECTION	6,300.00	SQYD
0230	05992	AGRICULTURAL LIMESTONE	3.90	TON
0235	06514	PAVE STRIPING-PERM PAINT-4 IN	4,012.00	LF
0240	06530	PAVE STRIPING REMOVAL-4 IN	119,000.00	LF
0245	06549	PAVE STRIPING-TEMP REM TAPE-B	11,478.00	LF
0250	06550	PAVE STRIPING-TEMP REM TAPE-W	7,652.00	LF
0255	06551	PAVE STRIPING-TEMP REM TAPE-Y	3,826.00	LF
0260	06565	PAVE MARKING-THERMO X-WALK-6 IN	914.00	LF
0265	06568	PAVE MARKING-THERMO STOP BAR-24IN	659.00	LF
0270	06569	PAVE MARKING-THERMO CROSS-HATCH	1,035.00	SQFT
0275	06574	PAVE MARKING-THERMO CURV ARROW	82.00	EACH
0280	06575	PAVE MARKING-THERMO COMB ARROW	46.00	EACH
0285	06576	PAVE MARKING-THERMO ONLY	2.00	EACH
0290	06578	PAVE MARKING-THERMO MERGE ARROW	2.00	EACH
0295	06598	PAVEMENT MARKING REMOVAL	1,219.00	SQFT
0300	22520EN	PAVE MARKING-THERMO YIELD BAR-36 IN	24.00	LF
0305	23131ER701	PIPELINE VIDEO INSPECTION	14,358.00	LF
0310	23158ES505	DETECTABLE WARNINGS	213.00	SQFT
0315	23956EC	PIPE REPAIR	24.00	EACH
0320	24489EC	INLAID PAVEMENT MARKER	729.00	EACH
0325	24679ED	PAVE MARK THERMO CHEVRON	2,784.00	SQFT
0330	24995EC	PAVE STRIPING-SPRAY THERMO-6 IN W	34,956.00	LF
0335	24996EC	PAVE STRIPING-SPRAY THERMO-6 IN Y	14,398.00	LF
0340	00071	CRUSHED AGGREGATE SIZE NO 57	60.50	TON
0345	00520	STORM SEWER PIPE-12 IN	110.00	LF
0350	00521	STORM SEWER PIPE-15 IN	1,641.00	LF
0355	00522	STORM SEWER PIPE-18 IN	1,407.00	LF
0360	00528	STORM SEWER PIPE-36 IN	16.00	LF
0365	00980	SLOTTED DRAIN PIPE-12 IN	400.00	LF
0370	01000	PERFORATED PIPE-4 IN	827.00	LF
0375	01310	REMOVE PIPE	22.00	LF
0380	01456	CURB BOX INLET TYPE A	30.00	EACH
0385	01458	CURB BOX INLET TYPE A T	2.00	EACH
0390	01459	CURB BOX INLET TYPE A MOD	2.00	EACH
0395	01480	CURB BOX INLET TYPE B	6.00	EACH
0400	01487	CURB BOX INLET TYPE F	24.00	EACH
0405	01490	DROP BOX INLET TYPE 1	1.00	EACH
0410	01581	DROP BOX INLET TYPE 16G	14.00	EACH
0415	01586	DROP BOX INLET TYPE 16GT	8.00	EACH
0420	01767	MANHOLE TYPE C	1.00	EACH
0425	01895	VALLEY GUTTER	590.00	LF
0430	02604	FABRIC-GEOTEXTILE CLASS 1A	368.00	SQYD
0435	02690	SAFELOADING	5.70	CUYD
0440	03385	PVC PIPE-6 IN	8.00	LF
0445	20098NC	CAP BOX INLET	4.00	EACH
0450	23822EC	CORED HOLE DRAINAGE BOX CON-15 IN	12.00	EACH
0455	23952EC	DRAINAGE JUNCTION BOX TY B	3.00	EACH
0460	02569	DEMOBILIZATION	1.00	LS

MATERIAL SUMMARY

CONTRACT ID: 201024

047GR20D024-NHPP-HSIP

DE047031W2025

US-31W INTERSECTION AND CORRIDOR IMPROVEMENTS TO REDUCE CONFLICT POINTS AND ENHANCE SAFETY & CAPACITY ALONG US 31W FROM DIECKS DR TO PINE VALLEY DR ASPHALT REHAB WITH GRADE & DRAIN, A DISTANCE OF 3.11 MILES.

Project Line No	Bid Code	DESCRIPTION	Quantity	Unit
0465	00001	DGA BASE	281.00	TON
0470	00003	CRUSHED STONE BASE	1,844.00	TON
0475	00100	ASPHALT SEAL AGGREGATE	2.00	TON
0480	00103	ASPHALT SEAL COAT	1.00	TON
0485	00214	CL3 ASPH BASE 1.00D PG64-22	1,310.00	TON
0490	00216	CL3 ASPH BASE 1.00D PG76-22	909.00	TON
0495	00336	CL3 ASPH SURF 0.38A PG76-22	12,684.00	TON
0500	24780EC	INTELLIGENT COMPACTION FOR AGGREGATE	1,844.00	TON
0505	24781EC	INTELLIGENT COMPACTION FOR ASPHALT - (REVISED: 8-19-20)	14,903.00	TON
0510	24785EC	FIBER REINFORCEMENT FOR HMA	13,593.00	TON
0515	24891EC	PAVE MOUNT INFRARED TEMP EQUIPMENT	142,380.00	SF
0520	24970EC	ASPHALT MATERIAL FOR TACK NON-TRACKING	5.00	TON
0525	01810	STANDARD CURB AND GUTTER	1,357.00	LF
0530	01811	STANDARD CURB AND GUTTER MOD	271.00	LF
0535	01820	LIP CURB AND GUTTER	57.00	LF
0540	01875	STANDARD HEADER CURB	203.00	LF
0545	01891	ISLAND HEADER CURB TYPE 2	241.00	LF
0550	01904	REMOVE CURB	448.00	LF
0555	01917	STANDARD BARRIER MEDIAN TYPE 2 - (REVISED: 8-19-20)	587.00	SQYD
0560	01921	STANDARD BARRIER MEDIAN TYPE 4 - (REVISED: 8-19-20)	4,756.00	SQYD
0565	01982	DELINEATOR FOR GUARDRAIL MONO DIRECTIONAL WHITE	10.00	EACH
0570	02014	BARRICADE-TYPE III	208.00	EACH
0575	02091	REMOVE PAVEMENT	2,241.00	SQYD
0580	02159	TEMP DITCH	850.00	LF
0585	02160	CLEAN TEMP DITCH	425.00	LF
0590	02200	ROADWAY EXCAVATION - (REVISED: 8-19-20)	4,483.00	CUYD
0595	02203	STRUCTURE EXCAV-UNCLASSIFIED	19.00	CUYD
0600	02223	GRANULAR EMBANKMENT	9.00	CUYD
0605	02237	DITCHING	500.00	LF
0610	02242	WATER	262.00	MGAL
0615	02351	GUARDRAIL-STEEL W BEAM-S FACE	512.50	LF
0620	02369	GUARDRAIL END TREATMENT TYPE 2A	1.00	EACH
0625	02381	REMOVE GUARDRAIL	201.00	LF
0630	02391	GUARDRAIL END TREATMENT TYPE 4A	1.00	EACH
0635	02429	RIGHT-OF-WAY MONUMENT TYPE 1	5.00	EACH
0640	02432	WITNESS POST	2.00	EACH
0645	02483	CHANNEL LINING CLASS II	167.00	TON
0650	02545	CLEARING AND GRUBBING - 4.0 ACRES-4-9008.50	1.00	LS
0655	02555	CONCRETE-CLASS B	9.30	CUYD

MATERIAL SUMMARY

Project Line No	Bid Code	DESCRIPTION	Quantity	Unit
0660	02562	TEMPORARY SIGNS	1,950.00	SQFT
0665	02570	PROJECT CPM SCHEDULE - 4-9008.50	1.00	LS
0670	02607	FABRIC-GEOTEXTILE CLASS 2 FOR PIPE	3,452.00	SQYD
0675	02611	HANDRAIL-TYPE A-1	52.00	LF
0680	02650	MAINTAIN & CONTROL TRAFFIC - 4-9008.50	1.00	LS
0685	02671	PORTABLE CHANGEABLE MESSAGE SIGN	6.00	EACH
0690	02696	SHOULDER RUMBLE STRIPS	325.00	LF
0695	02701	TEMP SILT FENCE	850.00	LF
0700	02703	SILT TRAP TYPE A	4.00	EACH
0705	02704	SILT TRAP TYPE B	4.00	EACH
0710	02705	SILT TRAP TYPE C	4.00	EACH
0715	02706	CLEAN SILT TRAP TYPE A	4.00	EACH
0720	02707	CLEAN SILT TRAP TYPE B	4.00	EACH
0725	02708	CLEAN SILT TRAP TYPE C	4.00	EACH
0730	02720	SIDEWALK-4 IN CONCRETE	818.00	SQYD
0735	02721	REMOVE CONCRETE SIDEWALK	6.00	SQYD
0740	02775	ARROW PANEL	4.00	EACH
0745	03262	CLEAN PIPE STRUCTURE	19.00	EACH
0750	04811	ELECTRICAL JUNCTION BOX TYPE B	16.00	EACH
0755	04820	TRENCHING AND BACKFILLING	990.00	LF
0760	04844	CABLE-NO. 14/5C	1,400.00	LF
0765	04953	TEMP RELOCATION OF SIGNAL HEAD	113.00	EACH
0770	04960	REMOVE AND REPLACE SIDEWALK	50.00	SQYD
0775	05950	EROSION CONTROL BLANKET	1,215.00	SQYD
0780	05952	TEMP MULCH	5,250.00	SQYD
0785	05953	TEMP SEEDING AND PROTECTION	3,900.00	SQYD
0790	05963	INITIAL FERTILIZER	.23	TON
0795	05964	MAINTENANCE FERTILIZER	.38	TON
0800	05985	SEEDING AND PROTECTION	7,300.00	SQYD
0805	05992	AGRICULTURAL LIMESTONE	4.50	TON
0810	06510	PAVE STRIPING-TEMP PAINT-4 IN	321,000.00	LF
0815	06514	PAVE STRIPING-PERM PAINT-4 IN	3,797.00	LF
0820	06530	PAVE STRIPING REMOVAL-4 IN	82,000.00	LF
0825	06544	PAVE STRIPING-THERMO-8 IN W	190.00	LF
0830	06549	PAVE STRIPING-TEMP REM TAPE-B	10,911.00	LF
0835	06550	PAVE STRIPING-TEMP REM TAPE-W	7,274.00	LF
0840	06551	PAVE STRIPING-TEMP REM TAPE-Y	3,637.00	LF
0845	06565	PAVE MARKING-THERMO X-WALK-6 IN	937.00	LF
0850	06568	PAVE MARKING-THERMO STOP BAR-24IN	591.00	LF
0855	06569	PAVE MARKING-THERMO CROSS-HATCH	2,029.00	SQFT
0860	06573	PAVE MARKING-THERMO STR ARROW	1.00	EACH
0865	06574	PAVE MARKING-THERMO CURV ARROW	44.00	EACH
0870	06575	PAVE MARKING-THERMO COMB ARROW	43.00	EACH
0875	06576	PAVE MARKING-THERMO ONLY	1.00	EACH
0880	06598	PAVEMENT MARKING REMOVAL	1,499.00	SQFT
0885	20093NS835	INSTALL PEDESTRIAN HEAD-LED	15.00	EACH
0890	20314ED	MILLED RUMBLE STRIPS	190.00	LF
0895	20411ED	LAW ENFORCEMENT OFFICER	160.00	HOURL
0900	22520EN	PAVE MARKING-THERMO YIELD BAR-36 IN	53.00	LF
0905	23131ER701	PIPELINE VIDEO INSPECTION	10,623.00	LF

MATERIAL SUMMARY

Project Line No	Bid Code	DESCRIPTION	Quantity	Unit
0910	23158ES505	DETECTABLE WARNINGS	268.00	SQFT
0915	23235EC	INSTALL PEDESTAL POST	9.00	EACH
0920	23274EN11F	TURF REINFORCEMENT MAT 1	6.00	SQYD
0925	23956EC	PIPE REPAIR	19.00	EACH
0930	24489EC	INLAID PAVEMENT MARKER	414.00	EACH
0935	24679ED	PAVE MARK THERMO CHEVRON	2,561.00	SQFT
0940	24768EC	LANE SEPARATOR CURB	4,500.00	LF
0945	24810ED	SIDEWALK FLUME - 4-9008	1.00	EACH
0950	24901EC	PVC CONDUIT-2 IN-SCHEDULE 80	1,980.00	LF
0955	24955ED	REMOVE SIGNAL EQUIPMENT	2.00	EACH
0960	24995EC	PAVE STRIPING-SPRAY THERMO-6 IN W	22,697.00	LF
0965	24996EC	PAVE STRIPING-SPRAY THERMO-6 IN Y	11,738.00	LF
0970	00071	CRUSHED AGGREGATE SIZE NO 57	581.50	TON
0975	00520	STORM SEWER PIPE-12 IN	195.00	LF
0980	00521	STORM SEWER PIPE-15 IN	1,416.00	LF
0985	00522	STORM SEWER PIPE-18 IN	987.00	LF
0990	00524	STORM SEWER PIPE-24 IN	142.00	LF
0995	00552	STORM SEWER PIPE-18 IN EQUIV	4.00	LF
1000	00980	SLOTTED DRAIN PIPE-12 IN	160.00	LF
1005	01000	PERFORATED PIPE-4 IN	7,322.00	LF
1010	01010	NON-PERFORATED PIPE-4 IN	197.00	LF
1015	01015	INSPECT & CERTIFY EDGE DRAIN SYSTEM - 4-9008.50	1.00	LS
1020	01310	REMOVE PIPE	185.00	LF
1025	01432	SLOPED BOX OUTLET TYPE 1-15 IN	1.00	EACH
1030	01456	CURB BOX INLET TYPE A	32.00	EACH
1035	01480	CURB BOX INLET TYPE B	5.00	EACH
1040	01487	CURB BOX INLET TYPE F	13.00	EACH
1045	01490	DROP BOX INLET TYPE 1	6.00	EACH
1050	01511	DROP BOX INLET TYPE 5D	1.00	EACH
1055	01541	DROP BOX INLET TYPE 10	1.00	EACH
1060	01581	DROP BOX INLET TYPE 16G	5.00	EACH
1065	01586	DROP BOX INLET TYPE 16GT	5.00	EACH
1070	01719	ADJUST INLET	1.00	EACH
1075	01740	CORED HOLE DRAINAGE BOX CON-4 IN	10.00	EACH
1080	01756	MANHOLE TYPE A	2.00	EACH
1085	01792	ADJUST MANHOLE	4.00	EACH
1090	01895	VALLEY GUTTER	240.00	LF
1095	02604	FABRIC-GEOTEXTILE CLASS 1A	3,342.00	SQYD
1100	02690	SAFELOADING	23.90	CUYD
1105	03385	PVC PIPE-6 IN	4.00	LF
1110	20098NC	CAP BOX INLET	9.00	EACH
1115	21541NN	CORED HOLE DRAINAGE BOX CON- 18 IN	3.00	EACH
1120	23822EC	CORED HOLE DRAINAGE BOX CON-15 IN	14.00	EACH
1125	23952EC	DRAINAGE JUNCTION BOX TY B	2.00	EACH
1130	15094	S MANHOLE ADJUST TO GRADE	2.00	EACH
1135	16064	G VALVE BOX ADJUST	1.00	EACH
1140	16565	G LINE MARKER INST	1.00	EACH
1145	02569	DEMOBILIZATION	1.00	LS

MATERIAL SUMMARY

CONTRACT ID: 201024

047GR20D024-NHPP-HSIP

DE047031W2026

US-31W ADDRESS PAVEMENT CONDITION ON US-31W IN HARDIN COUNTY ASPHALT REHAB WITH GRADE & DRAIN, A DISTANCE OF 2.76 MILES.

Project Line No	Bid Code	DESCRIPTION	Quantity	Unit
1150	00001	DGA BASE	1,719.00	TON
1155	00003	CRUSHED STONE BASE - (REVISED: 8-19-20)	14,808.00	TON
1160	00100	ASPHALT SEAL AGGREGATE	66.00	TON
1165	00103	ASPHALT SEAL COAT	8.00	TON
1170	00194	LEVELING & WEDGING PG76-22	8,405.00	TON
1175	00214	CL3 ASPH BASE 1.00D PG64-22 - (REVISED: 8-19-20)	11,497.00	TON
1180	00216	CL3 ASPH BASE 1.00D PG76-22	37,422.00	TON
1185	00336	CL3 ASPH SURF 0.38A PG76-22	1,909.00	TON
1190	00339	CL3 ASPH SURF 0.38D PG64-22	1,500.00	TON
1195	02101	CEM CONC ENT PAVEMENT-8 IN	331.00	SQYD
1200	24780EC	INTELLIGENT COMPACTION FOR AGGREGATE - (REVISED: 8-19-20)	14,808.00	TON
1205	24781EC	INTELLIGENT COMPACTION FOR ASPHALT - (REVISED: 8-19-20)	59,233.00	TON
1210	24785EC	FIBER REINFORCEMENT FOR HMA	39,331.00	TON
1215	24891EC	PAVE MOUNT INFRARED TEMP EQUIPMENT	3,554,874.00	SF
1220	24970EC	ASPHALT MATERIAL FOR TACK NON-TRACKING - (REVISED: 8-19-20)	101.00	TON
1225	01810	STANDARD CURB AND GUTTER	1,642.00	LF
1230	01811	STANDARD CURB AND GUTTER MOD	1,542.00	LF
1235	01812	REMOVE CURB AND GUTTER	202.00	LF
1240	01921	STANDARD BARRIER MEDIAN TYPE 4	2,424.00	SQYD
1245	02091	REMOVE PAVEMENT	176.00	SQYD
1250	02159	TEMP DITCH	200.00	LF
1255	02160	CLEAN TEMP DITCH	100.00	LF
1260	02200	ROADWAY EXCAVATION - (REVISED: 8-19-20)	12,825.00	CUYD
1265	02237	DITCHING	500.00	LF
1270	02585	EDGE KEY	7,400.00	LF
1275	02607	FABRIC-GEOTEXTILE CLASS 2 FOR PIPE	881.00	SQYD
1280	02676	MOBILIZATION FOR MILL & TEXT - 4-20011	1.00	LS
1285	02677	ASPHALT PAVE MILLING & TEXTURING	37,629.00	TON
1290	02701	TEMP SILT FENCE	200.00	LF
1295	02703	SILT TRAP TYPE A	2.00	EACH
1300	02704	SILT TRAP TYPE B	2.00	EACH
1305	02705	SILT TRAP TYPE C	2.00	EACH
1310	02706	CLEAN SILT TRAP TYPE A	2.00	EACH
1315	02707	CLEAN SILT TRAP TYPE B	2.00	EACH
1320	02708	CLEAN SILT TRAP TYPE C	2.00	EACH
1325	02720	SIDEWALK-4 IN CONCRETE	1,439.00	SQYD
1330	03262	CLEAN PIPE STRUCTURE	6.00	EACH
1335	05950	EROSION CONTROL BLANKET	427.00	SQYD
1340	05952	TEMP MULCH	1,500.00	SQYD
1345	05953	TEMP SEEDING AND PROTECTION	1,100.00	SQYD
1350	05963	INITIAL FERTILIZER	.06	TON
1355	05964	MAINTENANCE FERTILIZER	.10	TON

MATERIAL SUMMARY

Project Line No	Bid Code	DESCRIPTION	Quantity	Unit
1360	05985	SEEDING AND PROTECTION	1,900.00	SQYD
1365	05992	AGRICULTURAL LIMESTONE	1.20	TON
1370	06514	PAVE STRIPING-PERM PAINT-4 IN	399.00	LF
1375	06530	PAVE STRIPING REMOVAL-4 IN	41,000.00	LF
1380	06549	PAVE STRIPING-TEMP REM TAPE-B	3,990.00	LF
1385	06550	PAVE STRIPING-TEMP REM TAPE-W	2,660.00	LF
1390	06551	PAVE STRIPING-TEMP REM TAPE-Y	1,330.00	LF
1395	06565	PAVE MARKING-THERMO X-WALK-6 IN	149.00	LF
1400	06568	PAVE MARKING-THERMO STOP BAR-24IN	162.00	LF
1405	06569	PAVE MARKING-THERMO CROSS-HATCH	253.00	SQFT
1410	06573	PAVE MARKING-THERMO STR ARROW	3.00	EACH
1415	06574	PAVE MARKING-THERMO CURV ARROW	20.00	EACH
1420	06575	PAVE MARKING-THERMO COMB ARROW	8.00	EACH
1425	06576	PAVE MARKING-THERMO ONLY	5.00	EACH
1430	06598	PAVEMENT MARKING REMOVAL	529.00	SQFT
1435	10020NS	FUEL ADJUSTMENT	119,212.00	DOLL
1440	10030NS	ASPHALT ADJUSTMENT	278,137.00	DOLL
1445	20550ND	SAWCUT PAVEMENT - (REVISED: 8-19-20)	40,803.00	LF
1450	21289ED	LONGITUDINAL EDGE KEY	32,000.00	LF
1455	22520EN	PAVE MARKING-THERMO YIELD BAR-36 IN	12.00	LF
1460	23131ER701	PIPELINE VIDEO INSPECTION	3,688.00	LF
1465	23158ES505	DETECTABLE WARNINGS	117.00	SQFT
1470	23956EC	PIPE REPAIR	6.00	EACH
1475	24261EC	ISLAND CURB AND GUTTER(MODIFIED)	86.00	LF
1480	24489EC	INLAID PAVEMENT MARKER	170.00	EACH
1485	24679ED	PAVE MARK THERMO CHEVRON	1,723.00	SQFT
1490	24995EC	PAVE STRIPING-SPRAY THERMO-6 IN W	9,383.00	LF
1495	24996EC	PAVE STRIPING-SPRAY THERMO-6 IN Y	5,196.00	LF
1500	00071	CRUSHED AGGREGATE SIZE NO 57	291.00	TON
1505	00520	STORM SEWER PIPE-12 IN	24.00	LF
1510	00521	STORM SEWER PIPE-15 IN	637.00	LF
1515	00522	STORM SEWER PIPE-18 IN	24.00	LF
1520	00524	STORM SEWER PIPE-24 IN	4.00	LF
1525	00980	SLOTTED DRAIN PIPE-12 IN	120.00	LF
1530	01000	PERFORATED PIPE-4 IN	3,856.00	LF
1535	01010	NON-PERFORATED PIPE-4 IN	97.00	LF
1540	01032	PERF PIPE HEADWALL TY 4-4 IN	1.00	EACH
1545	01202	PIPE CULVERT HEADWALL-15 IN	2.00	EACH
1550	01456	CURB BOX INLET TYPE A	10.00	EACH
1555	01459	CURB BOX INLET TYPE A MOD	4.00	EACH
1560	01487	CURB BOX INLET TYPE F	2.00	EACH
1565	01490	DROP BOX INLET TYPE 1	1.00	EACH
1570	01581	DROP BOX INLET TYPE 16G	1.00	EACH
1575	01586	DROP BOX INLET TYPE 16GT	5.00	EACH
1580	01718	REMOVE INLET	1.00	EACH
1585	01740	CORED HOLE DRAINAGE BOX CON-4 IN	6.00	EACH
1590	01895	VALLEY GUTTER	180.00	LF
1595	02604	FABRIC-GEOTEXTILE CLASS 1A	1,758.00	SQYD
1600	20098NC	CAP BOX INLET	4.00	EACH
1605	23822EC	CORED HOLE DRAINAGE BOX CON-15 IN	5.00	EACH

MATERIAL SUMMARY

Project Line No	Bid Code	DESCRIPTION	Quantity	Unit
1610	23952EC	DRAINAGE JUNCTION BOX TY B	1.00	EACH
1615	15094	S MANHOLE ADJUST TO GRADE	2.00	EACH
1620	04793	CONDUIT-1 1/4 IN	140.00	LF
1625	04795	CONDUIT-2 IN	55.00	LF
1630	04820	TRENCHING AND BACKFILLING	180.00	LF
1635	04829	PIEZOELECTRIC SENSOR	13.00	EACH
1640	04830	LOOP WIRE	6,450.00	LF
1645	04895	LOOP SAW SLOT AND FILL	1,440.00	LF
1650	20359NN	GALVANIZED STEEL CABINET	4.00	EACH
1655	20360ES818	WOOD POST	9.00	EACH
1660	20391NS835	ELECTRICAL JUNCTION BOX TYPE A	4.00	EACH
1665	20468EC	ELECTRICAL JUNCTION BOX-10 X 8 X 4	1.00	EACH
1670	02568	MOBILIZATION	1.00	LS
1675	02569	DEMOBILIZATION	1.00	LS
1680	25010EC	GEOCOMPOSITE REINFORCEMENT FOR ASPHALT - (ADDED: 8-19-20)	10,453.00	SQYD

PROPOSAL BID ITEMS

201024

Page 1 of 5

Report Date 8/19/20

Section: 0001 - PAVING

LINE	BID CODE	ALT	DESCRIPTION	QUANTITY	UNIT	UNIT PRIC	FP	AMOUNT
0010	00001		DGA BASE	2,000.00	TON		\$	
0020	00003		CRUSHED STONE BASE	17,138.00	TON		\$	
0030	00100		ASPHALT SEAL AGGREGATE	68.00	TON		\$	
0040	00103		ASPHALT SEAL COAT	9.00	TON		\$	
0050	00194		LEVELING & WEDGING PG76-22	8,405.00	TON		\$	
0060	00214		CL3 ASPH BASE 1.00D PG64-22	13,126.00	TON		\$	
0070	00216		CL3 ASPH BASE 1.00D PG76-22	38,650.00	TON		\$	
0080	00336		CL3 ASPH SURF 0.38A PG76-22	14,797.00	TON		\$	
0090	00339		CL3 ASPH SURF 0.38D PG64-22	1,500.00	TON		\$	
0100	02101		CEM CONC ENT PAVEMENT-8 IN	331.00	SQYD		\$	
0120	24780EC		INTELLIGENT COMPACTION FOR AGGREGATE	17,138.00	TON		\$	
0130	24781EC		INTELLIGENT COMPACTION FOR ASPHALT	74,978.00	TON		\$	
0140	24785EC		FIBER REINFORCEMENT FOR HMA	53,447.00	TON		\$	
0150	24891EC		PAVE MOUNT INFRARED TEMP EQUIPMENT	3,751,587.00	SF		\$	
0160	24970EC		ASPHALT MATERIAL FOR TACK NON-TRACKING	108.00	TON		\$	
0165	25010EC		GEOCOMPOSITE REINFORCEMENT FOR ASPHALT (ADDED: 8-19-20)	10,453.00	SQYD		\$	

Section: 0002 - ROADWAY

LINE	BID CODE	ALT	DESCRIPTION	QUANTITY	UNIT	UNIT PRIC	FP	AMOUNT
0170	01810		STANDARD CURB AND GUTTER	3,585.00	LF		\$	
0180	01811		STANDARD CURB AND GUTTER MOD	2,545.00	LF		\$	
0190	01812		REMOVE CURB AND GUTTER	202.00	LF		\$	
0200	01820		LIP CURB AND GUTTER	57.00	LF		\$	
0210	01875		STANDARD HEADER CURB	246.00	LF		\$	
0220	01891		ISLAND HEADER CURB TYPE 2	693.00	LF		\$	
0230	01904		REMOVE CURB	473.00	LF		\$	
0240	01917		STANDARD BARRIER MEDIAN TYPE 2	587.00	SQYD		\$	
0250	01921		STANDARD BARRIER MEDIAN TYPE 4	13,177.00	SQYD		\$	
0260	01982		DELINEATOR FOR GUARDRAIL MONO DIRECTIONAL WHITE	10.00	EACH		\$	
0270	02014		BARRICADE-TYPE III	208.00	EACH		\$	
0280	02091		REMOVE PAVEMENT	4,213.00	SQYD		\$	
0290	02159		TEMP DITCH	1,710.00	LF		\$	
0300	02160		CLEAN TEMP DITCH	855.00	LF		\$	
0310	02200		ROADWAY EXCAVATION	21,752.00	CUYD		\$	
0320	02203		STRUCTURE EXCAV-UNCLASSIFIED	51.00	CUYD		\$	
0330	02223		GRANULAR EMBANKMENT	23.00	CUYD		\$	
0340	02237		DITCHING	1,500.00	LF		\$	
0350	02242		WATER	262.00	MGAL		\$	
0360	02351		GUARDRAIL-STEEL W BEAM-S FACE	512.50	LF		\$	
0370	02369		GUARDRAIL END TREATMENT TYPE 2A	1.00	EACH		\$	
0380	02381		REMOVE GUARDRAIL	201.00	LF		\$	

PROPOSAL BID ITEMS

201024

Page 2 of 5

Report Date 8/19/20

LINE	BID CODE	ALT	DESCRIPTION	QUANTITY	UNIT	UNIT PRIC	FP	AMOUNT
0390	02391		GUARDRAIL END TREATMENT TYPE 4A	1.00	EACH		\$	
0400	02429		RIGHT-OF-WAY MONUMENT TYPE 1	7.00	EACH		\$	
0410	02432		WITNESS POST	3.00	EACH		\$	
0420	02483		CHANNEL LINING CLASS II	189.00	TON		\$	
0430	02545		CLEARING AND GRUBBING 4.0 ACRES-4-9008.50	1.00	LS		\$	
0440	02555		CONCRETE-CLASS B	24.10	CUYD		\$	
0450	02562		TEMPORARY SIGNS	1,950.00	SQFT		\$	
0460	02570		PROJECT CPM SCHEDULE 4-9008.50	1.00	LS		\$	
0470	02585		EDGE KEY	7,400.00	LF		\$	
0480	02607		FABRIC-GEOTEXTILE CLASS 2 FOR PIPE	8,525.00	SQYD	\$2.00	\$	\$17,050.00
0490	02611		HANDRAIL-TYPE A-1	119.00	LF		\$	
0500	02650		MAINTAIN & CONTROL TRAFFIC 4-9008.50	1.00	LS		\$	
0510	02671		PORTABLE CHANGEABLE MESSAGE SIGN	6.00	EACH		\$	
0520	02676		MOBILIZATION FOR MILL & TEXT 4-20011	1.00	LS		\$	
0530	02677		ASPHALT PAVE MILLING & TEXTURING	37,629.00	TON		\$	
0540	02696		SHOULDER RUMBLE STRIPS	325.00	LF		\$	
0550	02701		TEMP SILT FENCE	1,710.00	LF		\$	
0560	02703		SILT TRAP TYPE A	11.00	EACH		\$	
0570	02704		SILT TRAP TYPE B	11.00	EACH		\$	
0580	02705		SILT TRAP TYPE C	11.00	EACH		\$	
0590	02706		CLEAN SILT TRAP TYPE A	11.00	EACH		\$	
0600	02707		CLEAN SILT TRAP TYPE B	11.00	EACH		\$	
0610	02708		CLEAN SILT TRAP TYPE C	11.00	EACH		\$	
0620	02720		SIDEWALK-4 IN CONCRETE	2,625.00	SQYD		\$	
0630	02721		REMOVE CONCRETE SIDEWALK	6.00	SQYD		\$	
0640	02726		STAKING 154.20	1.00	LS		\$	
0650	02775		ARROW PANEL	4.00	EACH		\$	
0660	03262		CLEAN PIPE STRUCTURE	49.00	EACH		\$	
0670	04811		ELECTRICAL JUNCTION BOX TYPE B	16.00	EACH		\$	
0680	04820		TRENCHING AND BACKFILLING	990.00	LF		\$	
0690	04844		CABLE-NO. 14/5C	1,400.00	LF		\$	
0700	04953		TEMP RELOCATION OF SIGNAL HEAD	113.00	EACH		\$	
0710	04960		REMOVE AND REPLACE SIDEWALK	76.00	SQYD		\$	
0720	05950		EROSION CONTROL BLANKET	2,927.00	SQYD		\$	
0730	05952		TEMP MULCH	11,450.00	SQYD		\$	
0740	05953		TEMP SEEDING AND PROTECTION	8,450.00	SQYD		\$	
0750	05963		INITIAL FERTILIZER	.49	TON		\$	
0760	05964		MAINTENANCE FERTILIZER	.81	TON		\$	
0770	05985		SEEDING AND PROTECTION	15,500.00	SQYD		\$	
0780	05992		AGRICULTURAL LIMESTONE	9.60	TON		\$	
0790	06510		PAVE STRIPING-TEMP PAINT-4 IN	321,000.00	LF		\$	
0800	06514		PAVE STRIPING-PERM PAINT-4 IN	8,208.00	LF		\$	
0810	06530		PAVE STRIPING REMOVAL-4 IN	242,000.00	LF		\$	
0820	06544		PAVE STRIPING-THERMO-8 IN W	190.00	LF		\$	
0830	06549		PAVE STRIPING-TEMP REM TAPE-B	26,379.00	LF		\$	
0840	06550		PAVE STRIPING-TEMP REM TAPE-W	17,586.00	LF		\$	

PROPOSAL BID ITEMS

201024

Page 3 of 5

Report Date 8/19/20

LINE	BID CODE	ALT	DESCRIPTION	QUANTITY	UNIT	UNIT PRIC	FP	AMOUNT
0850	06551		PAVE STRIPING-TEMP REM TAPE-Y	8,793.00	LF		\$	
0860	06565		PAVE MARKING-THERMO X-WALK-6 IN	2,000.00	LF		\$	
0870	06568		PAVE MARKING-THERMO STOP BAR-24IN	1,412.00	LF		\$	
0880	06569		PAVE MARKING-THERMO CROSS-HATCH	3,317.00	SQFT		\$	
0890	06573		PAVE MARKING-THERMO STR ARROW	4.00	EACH		\$	
0900	06574		PAVE MARKING-THERMO CURV ARROW	146.00	EACH		\$	
0910	06575		PAVE MARKING-THERMO COMB ARROW	97.00	EACH		\$	
0920	06576		PAVE MARKING-THERMO ONLY	8.00	EACH		\$	
0930	06578		PAVE MARKING-THERMO MERGE ARROW	2.00	EACH		\$	
0940	06598		PAVEMENT MARKING REMOVAL	3,247.00	SQFT		\$	
0950	10020NS		FUEL ADJUSTMENT	119,212.00	DOLL	\$1.00	\$	\$119,212.00
0960	10030NS		ASPHALT ADJUSTMENT	278,137.00	DOLL	\$1.00	\$	\$278,137.00
0970	20093NS835		INSTALL PEDESTRIAN HEAD-LED	15.00	EACH		\$	
0980	20314ED		MILLED RUMBLE STRIPS	190.00	LF		\$	
0990	20411ED		LAW ENFORCEMENT OFFICER	160.00	HOUR		\$	
1000	20550ND		SAWCUT PAVEMENT	40,803.00	LF		\$	
1010	21289ED		LONGITUDINAL EDGE KEY	32,000.00	LF		\$	
1020	22520EN		PAVE MARKING-THERMO YIELD BAR-36 IN	89.00	LF		\$	
1030	23131ER701		PIPELINE VIDEO INSPECTION	28,669.00	LF		\$	
1040	23158ES505		DETECTABLE WARNINGS	598.00	SQFT		\$	
1050	23235EC		INSTALL PEDESTAL POST	9.00	EACH		\$	
1060	23274EN11F		TURF REINFORCEMENT MAT 1	6.00	SQYD		\$	
1070	23956EC		PIPE REPAIR	49.00	EACH		\$	
1080	24261EC		ISLAND CURB AND GUTTER(MODIFIED)	86.00	LF		\$	
1090	24489EC		INLAID PAVEMENT MARKER	1,313.00	EACH		\$	
1100	24679ED		PAVE MARK THERMO CHEVRON	7,068.00	SQFT		\$	
1110	24768EC		LANE SEPARATOR CURB	4,500.00	LF		\$	
1120	24810ED		SIDEWALK FLUME 4-9008	1.00	EACH		\$	
1130	24901EC		PVC CONDUIT-2 IN-SCHEDULE 80	1,980.00	LF		\$	
1140	24955ED		REMOVE SIGNAL EQUIPMENT	2.00	EACH		\$	
1150	24995EC		PAVE STRIPING-SPRAY THERMO-6 IN W	67,036.00	LF		\$	
1160	24996EC		PAVE STRIPING-SPRAY THERMO-6 IN Y	31,332.00	LF		\$	

Section: 0003 - DRAINAGE

LINE	BID CODE	ALT	DESCRIPTION	QUANTITY	UNIT	UNIT PRIC	FP	AMOUNT
1170	00071		CRUSHED AGGREGATE SIZE NO 57	933.00	TON		\$	
1180	00520		STORM SEWER PIPE-12 IN	329.00	LF		\$	
1190	00521		STORM SEWER PIPE-15 IN	3,694.00	LF		\$	
1200	00522		STORM SEWER PIPE-18 IN	2,418.00	LF		\$	
1210	00524		STORM SEWER PIPE-24 IN	146.00	LF		\$	
1220	00528		STORM SEWER PIPE-36 IN	16.00	LF		\$	
1230	00552		STORM SEWER PIPE-18 IN EQUIV	4.00	LF		\$	
1240	00980		SLOTTED DRAIN PIPE-12 IN	680.00	LF		\$	
1250	01000		PERFORATED PIPE-4 IN	12,005.00	LF		\$	
1260	01010		NON-PERFORATED PIPE-4 IN	294.00	LF		\$	
1270	01015		INSPECT & CERTIFY EDGE DRAIN SYSTEM 4-9008.50	1.00	LS		\$	

PROPOSAL BID ITEMS

201024

Page 4 of 5

Report Date 8/19/20

LINE	BID CODE	ALT	DESCRIPTION	QUANTITY	UNIT	UNIT PRIC	FP	AMOUNT
1280	01032		PERF PIPE HEADWALL TY 4-4 IN	1.00	EACH		\$	
1290	01202		PIPE CULVERT HEADWALL-15 IN	2.00	EACH		\$	
1300	01310		REMOVE PIPE	207.00	LF		\$	
1310	01432		SLOPED BOX OUTLET TYPE 1-15 IN	1.00	EACH		\$	
1320	01456		CURB BOX INLET TYPE A	72.00	EACH		\$	
1330	01458		CURB BOX INLET TYPE A T	2.00	EACH		\$	
1340	01459		CURB BOX INLET TYPE A MOD	6.00	EACH		\$	
1350	01480		CURB BOX INLET TYPE B	11.00	EACH		\$	
1360	01487		CURB BOX INLET TYPE F	39.00	EACH		\$	
1370	01490		DROP BOX INLET TYPE 1	8.00	EACH		\$	
1380	01511		DROP BOX INLET TYPE 5D	1.00	EACH		\$	
1390	01541		DROP BOX INLET TYPE 10	1.00	EACH		\$	
1400	01581		DROP BOX INLET TYPE 16G	20.00	EACH		\$	
1410	01586		DROP BOX INLET TYPE 16GT	18.00	EACH		\$	
1420	01718		REMOVE INLET	1.00	EACH		\$	
1430	01719		ADJUST INLET	1.00	EACH		\$	
1440	01740		CORED HOLE DRAINAGE BOX CON-4 IN	16.00	EACH		\$	
1450	01756		MANHOLE TYPE A	2.00	EACH		\$	
1460	01767		MANHOLE TYPE C	1.00	EACH		\$	
1470	01792		ADJUST MANHOLE	4.00	EACH		\$	
1480	01895		VALLEY GUTTER	1,010.00	LF		\$	
1490	02604		FABRIC-GEOTEXTILE CLASS 1A	5,468.00	SQYD		\$	
1500	02690		SAFELOADING	29.60	CUYD		\$	
1510	03385		PVC PIPE-6 IN	12.00	LF		\$	
1520	20098NC		CAP BOX INLET	17.00	EACH		\$	
1530	21541NN		CORED HOLE DRAINAGE BOX CON- 18 IN	3.00	EACH		\$	
1540	23822EC		CORED HOLE DRAINAGE BOX CON-15 IN	31.00	EACH		\$	
1550	23952EC		DRAINAGE JUNCTION BOX TY B	6.00	EACH		\$	

Section: 0004 - UTILITY

LINE	BID CODE	ALT	DESCRIPTION	QUANTITY	UNIT	UNIT PRIC	FP	AMOUNT
1560	15094		S MANHOLE ADJUST TO GRADE	4.00	EACH		\$	
1570	16064		G VALVE BOX ADJUST	1.00	EACH		\$	
1580	16565		G LINE MARKER INST	1.00	EACH		\$	

Section: 0005 - TRAFFIC LOOPS

LINE	BID CODE	ALT	DESCRIPTION	QUANTITY	UNIT	UNIT PRIC	FP	AMOUNT
1590	04793		CONDUIT-1 1/4 IN	140.00	LF		\$	
1600	04795		CONDUIT-2 IN	55.00	LF		\$	
1610	04820		TRENCHING AND BACKFILLING	180.00	LF		\$	
1620	04829		PIEZOELECTRIC SENSOR	13.00	EACH		\$	
1630	04830		LOOP WIRE	6,450.00	LF		\$	
1640	04895		LOOP SAW SLOT AND FILL	1,440.00	LF		\$	
1650	20359NN		GALVANIZED STEEL CABINET	4.00	EACH		\$	
1660	20360ES818		WOOD POST	9.00	EACH		\$	

PROPOSAL BID ITEMS

201024

Page 5 of 5

Report Date 8/19/20

LINE	BID CODE	ALT	DESCRIPTION	QUANTITY	UNIT	UNIT PRIC	FP	AMOUNT
1670	20391NS835		ELECTRICAL JUNCTION BOX TYPE A	4.00	EACH		\$	
1680	20468EC		ELECTRICAL JUNCTION BOX-10 X 8 X 4	1.00	EACH		\$	

Section: 0006 - DEMOBILIZATION

LINE	BID CODE	ALT	DESCRIPTION	QUANTITY	UNIT	UNIT PRIC	FP	AMOUNT
1690	02568		MOBILIZATION	1.00	LS		\$	
1700	02569		DEMOBILIZATION	1.00	LS		\$	

SPECIAL NOTE FOR LANE SEPARATOR CURB

I. DESCRIPTION

Except as provided herein, perform all work in accordance with the Department's Standard Specifications, interim Supplemental Specifications, Standard and Sepia Drawings, and Special Notes and Special Provisions, current editions. Article references are to the Standard Specifications. This project shall consist of furnishing all labor, equipment, materials, and incidentals for the following:

(1) Maintaining and Controlling Traffic; (2) Installing Lane Separator Curb; and (3) All other work specified in the Contract.

II. MATERIALS

All materials shall be sampled and tested in accordance with the Department's Sampling Manual and the materials shall be available for sampling a sufficient time in advance of the use of the materials to allow for the necessary time for testing unless otherwise specified in these Notes.

A. Maintain and Control Traffic. See Traffic Control Plan.

B. Lane Separator Curb. Furnish a raised traffic separator curb guidance system which includes modular longitudinal curb sections and transition end sections, and delineator posts/panels. The longitudinal units of the Lane Separator Curb system shall interface with each other to form a continuous longitudinal channelizing system. The design of the system shall allow a radius or curve as needed by roadway geometry. The complete system shall be compliant with NCHRP 350 or MASH. Manufacturer's documentation validating this compliance shall be provided to the Engineer prior to installation. System color shall match the adjacent pavement marking color.

a. Longitudinal Units. The longitudinal units shall have a mountable design to allow for emergency vehicle crossovers. The longitudinal units shall be designed to allow for cross drainage under the units. Individual units of the system shall have a minimum length of 40 inches, maximum height of 4 inches and maximum width of 12 inches. The longitudinal base shall include retroreflective markings to match the system color. At least one upright post is required for each longitudinal curb unit.

b. Upright Posts. Upright posts shall be a minimum of 26 inches in height and a minimum of 2 inches in width. Upright posts are to be uniformly spaced at intervals no greater than 44 inches along the system. Post color should match the longitudinal curb unit and adjacent pavement marking color. Each post shall have retroreflective markings of color matching the post, longitudinal system, and adjacent pavement marking. Upright posts should be easily replaceable under traffic conditions and shall be fabricated to withstand repeated impacts and return to a complete upright position with minimal maintenance to the unit.

Lane Separator Curb
Page 2 of 2

III. CONSTRUCTION METHODS

- A. **Maintain and Control Traffic.** See Traffic Control Plan.
- B. **Site Preparation.** Be responsible for all site preparation including, but not limited to: clearing and grubbing, staking, excavation, backfill, and removal of obstructions or any other material not covered by other items. Perform site preparation only as approved, or directed, by the Engineer.
- C. **Lane Separator Curb.** Assemble and fasten the lane separator curb system to the underlying pavement or bridge deck according to the manufacturer's recommendations.
- D. **Property Damage.** The Contractor shall be responsible for all damage to public and/or private property resulting from the Contractor's activities. Repair or replace damaged roadway features in like kind materials and design as directed by the Engineer at no additional cost to the Department. Repair or replace damaged private property in like kind materials and design to the satisfaction of the owner and the Engineer at no additional cost to the Department.
- E. **Caution.** The information in this proposal and the type of work listed herein are approximate only and are not to be taken as an exact evaluation of the materials and conditions to be encountered during construction; the bidder must draw his/her own conclusions when developing the Unit Bid Prices for each bid item. As such, if the conditions encountered are not in accordance with the information shown, the Department does not guarantee any changes to the Unit Bid Prices nor extension of the contract will be considered. The Department will pay for bid item quantity overruns, but only if pre-approved by the Engineer.

IV. METHOD OF MEASUREMENT

- A. **Maintain and Control Traffic.** See Traffic Control Plan.
- B. **Site Preparation.** Other than the bid items listed, the Department will NOT measure Site Preparation for payment, but shall be incidental to the project bid items.
- C. **Lane Separator Curb.** The Department will measure Lane Separator Curb in Linear Feet.

V. BASIS OF PAYMENT

- A. **Maintain and Control Traffic.** See Traffic Control Plan.
- B. **Lane Separator Curb.** The Department will make payment for the completed and accepted quantities of Lane Separator Curb. Payment at the Contract unit price per linear foot shall be full compensation for furnishing all materials, equipment, tools, hardware, labor, and incidentals necessary to properly install the Lane Separator Curb according to the manufacturer's installation instructions, these notes, and/or as directed by the Engineer.

GENERAL SUMMARY

ITEM	DESCRIPTION	UNIT	4-154.20	4-20011.00	4-9008.50	TOTAL PROJECT
1810	STANDARD CURB AND GUTTER	LF	586	1642	1357	3585
1811	STANDARD CURB AND GUTTER MODIFIED	LF	732	1542	271	2545
1812	REMOVE CURB AND GUTTER	LF	0	202	0	202
1820	LIP CURB AND GUTTER	LF	0	0	57	57
1875	STANDARD HEADER CURB	LF	43	0	203	246
1891	ISLAND HEADER CURB TYPE 2	LF	452	0	241	693
1904	REMOVE CURB	LF	25	473	448	946
1917	STANDARD BARRIER MEDIUM TY 2	SY	0	0	587	587
1921	STANDARD BARRIER MEDIUM TY 4	SY	5997	2424	4756	13177
1982	DELINEATOR FOR GUARDRAIL - M/W	EACH	0	0	10	10
2014	BARRICADE TYPE III	EACH	0	0	208	208
2091	REMOVE PAVEMENT	SY	1796	176	2241	4213
2159	TEMPORARY DITCH	LF	660	200	850	1710
2160	CLEAN TEMPORARY DITCH	LF	330	100	425	855
2200	ROADWAY EXCAVATION	CY	4444	12825	4483	21752
2203	STRUCTURE EXCAVATION - UNCLASSIFIED	CY	32	0	51	83
2223	GRANULAR EMBANKMENT	CY	14	0	9	23
2237	DITCHING	LF	500	500	500	1500
2242	WATER	M GAL	0	0	262	262
2351	GUARDRAIL - STEEL W BEAM - SINGLE FACE	LF	0	0	512.5	512.5
2369	GUARDRAIL END TREATMENT TY 2A	EACH	0	0	1	1
2381	REMOVE GUARDRAIL	LF	0	0	201	201
2391	GUARDRAIL END TREATMENT TY 4A	EACH	0	0	1	1
2429	RIGHT-OF-WAY MONUMENT TYPE 1	EACH	2	0	5	7
2432	WITNESS POST	TON	1	0	2	3
2483	CHANNEL LINING CLASS II	TON	22	27	167	216
2545	CLEARING AND GRUBBING	LS	0	0	1	1
2555	CONCRETE - CLASS B	CY	14.8	0	9.3	24.1
2562	TEMPORARY SIGNS	SF	0	0	1950	1950
2568	MOBILIZATION	LS	0	1	0	1
2569	DEMOLITION	LS	1	1	1	3
2570	PROJECT GPM SCHEDULE	LS	0	0	1	1
2585	EDGE KEY	LF	0	7400	0	7400
2607	FABRIC-GEOTEXTILE CLASS 2 FOR PIPE	SY	4192	881	3452	8525
2611	HANDRAIL - TYPE A-1	LF	67	0	52	119
2650	MAINTAIN AND CONTROL TRAFFIC	LS	0	0	1	1
2671	PORTABLE CHANGEABLE MESSAGE SIGNS	EACH	0	0	6	6
2676	MOBILIZATION FOR MILL & TEXT	LS	0	1	0	1
2677	ASPHALT PAVE MILLING & TEXTURING	TON	0	37629	0	37629
2696	SHOULDER RUMBLE STRIPS	LF	0	325	0	325
2701	TEMPORARY SILT FENCE	LF	660	200	850	1710
2703	SILT TRAP TYPE A	EACH	5	2	4	11
2704	SILT TRAP TYPE B	EACH	5	2	4	11
2705	SILT TRAP TYPE C	EACH	5	2	4	11
2706	CLEAN SILT TRAP TYPE A	EACH	5	2	4	11
2707	CLEAN SILT TRAP TYPE B	EACH	5	2	4	11
2708	CLEAN SILT TRAP TYPE C	EACH	5	2	4	11
2721	REMOVE SIDEWALK	SY	368	1439	818	2625
2726	STAKING	LS	1	0	0	1
2775	ARROW PANEL	EACH	0	0	4	4
3262	CLEAN PIPE STRUCTURE	EACH	24	6	19	49
4953	TEMP RELOCATION OF SIGNAL HEAD	EACH	0	0	113	113
4960	REMOVE AND REPLACE SIDEWALK	SY	26	0	50	76
5950	EROSION CONTROL BLANKET	SY	1285	427	1215	2927
5952	TEMPORARY MULCH	SY	4700	1500	5250	11450
5953	TEMP SEEDING AND PROTECTION	SY	3450	1100	3900	8450
5963	INITIAL FERTILIZER	TON	0.20	0.06	0.23	0.49
5964	MAINTENANCE FERTILIZER	TON	0.33	0.10	0.38	0.81
5985	SEEDING AND PROTECTION	SY	6300	1900	7300	15500
5992	AGRICULTURAL LIMESTONE	TON	3.9	1.2	4.5	9.6

ITEM	DESCRIPTION	UNIT	4-154.20	4-20011.00	4-9008.50	TOTAL PROJECT
6510	PAVE STRIPING-TEMP PAINT - 4 INCH	LF	0	0	321000	321000
6514	PAVE STRIPING-PERM PAINT - 4 INCH	LF	4012	399	3797	8208
6530	PAVEMENT STRIPING REMOVAL - 4 INCH	LF	119000	41000	82000	242000
6549	PAVE STRIPING-TEMP REM TAPE-B	LF	11478	3990	10911	26379
6550	PAVE STRIPING-TEMP REM TAPE-W	LF	7652	2660	7274	17586
6551	PAVE STRIPING-TEMP REM TAPE-Y	LF	3826	1330	3637	8793
6565	PAVEMENT MARKING - THERMO X-WALK - 6 INCH	LF	914	149	937	2000
6568	PAVEMENT MARKING - THERMO STOP BAR - 24 INCH	LF	659	162	591	1412
6569	PAVEMENT MARKING - THERMO CROSS-HATCH	SF	1035	253	2029	3317
6573	PAVEMENT MARKING - THERMO STRAIGHT ARROW	EACH	0	3	1	4
6574	PAVEMENT MARKING - THERMO CURVE ARROW	EACH	82	20	44	146
6575	PAVEMENT MARKING - THERMO COMB ARROW	EACH	46	8	43	97
6578	PAVE MARKING - THERMO "ONLY"	EACH	2	5	1	8
6598	PAVEMENT MARKING - THERMO MERGE ARROW	EACH	2	0	0	2
6598	PAVEMENT MARKING REMOVAL	SF	1219	529	1499	3247
15094	S MANHOLE ADJUST TO GRADE	EACH	0	2	4	4
16064	G VALVE BOX ADJUST	EACH	0	0	1	1
16565	G LINE MARKER INST	EACH	0	0	1	1
10020NS	FUEL ADJUSTMENT	DOLLAR	0	129689	0	129689
10030NS	ASPHALT ADJUSTMENT	DOLLAR	0	298998	0	298998
20411ED	LAW ENFORCEMENT OFFICER	HOURL	0	0	160	160
20550ND	SAW CUT PAVEMENT	LF	0	40803	0	40803
21289ED	LONGITUDINAL EDGE KEY	LF	0	32000	0	32000
22520EN	PAVEMENT MARKING - THERMO YIELD BAR - 36 INCH	LF	24	12	53	89
23158E550S	DETECTABLE WARNINGS	SF	213	117	278	608
23274EN11F	TURF REINFORCEMENT MAT 1	SY	0	0	6	6
24489EC	INLAID PAVEMENT MARKERS	EACH	729	170	414	1313
24679ED	PAVE MARK THERMO CHEVRON	SF	2784	1723	2561	7068
24810ED	SIDEWALK FLUVE	EACH	0	0	1	1
24955ED	REMOVE SIGNAL EQUIPMENT	EACH	0	0	2	2
23131ER701	PIPELINE VIDEO INSPECTION	LF	14358	3688	10623	28669
23956EC	PIPE REPAIR	EACH	24	6	19	49
24995EC	PAVE STRIPING - SPRAY THERMO - 6 IN W	LF	34956	9383	22697	67036
24996EC	PAVE STRIPING - SPRAY THERMO - 6 IN Y	LF	14398	5196	11738	31332
24768EC	LANE SEPARATOR CURB	LF	0	0	4500	4500
24261EC	ISLAND CURB AND GUTTER (MODIFIED)	LF	0	86	0	86
06544	PAVE STRIPING - THERMO - 8 IN W	LF	0	0	190	190
20314ED	MILLED RUMBLE STRIPS	LF	0	0	190	190
04844	CABLE-NO. 14/5C	LF	0	0	1400	1400
24901EC	PVC CONDUIT-2 IN SCHEDULE 80	LF	0	0	1980	1980
04820	TRENCHING AND BACKFILLING	LF	0	0	990	990
04811	ELECTRICAL JUNCTION BOX TYPE B	EACH	0	0	16	16
20093NS835	INSTALL PEDESTRIAN HEAD - LED	EACH	0	0	15	15
23235EC	INSTALL PEDESTAL POST	EACH	0	0	9	9
20097E5601	CONCRETE CAP	LF	40	0	70	110

- ① APPROXIMATELY 4 ACRES TOTAL
 - ② FOR RETAINING WALL
 - ③ FOR MAINTENANCE OF TRAFFIC
 - ④ FOR THE REMOVAL OF ALL STRIPING AND MARKING THAT WILL CONFLICT WITH MAINTENANCE OF TRAFFIC OR FUTURE PROPOSED TRAFFIC PATTERNS AND MARKINGS. NO WATER BLASTING WILL BE PERMITTED ON FINAL SURFACE ASPHALT. - TEMPORARY STRIPING IN ITS FINAL LOCATION OR TEMPORARY TAPE TO BE USED ON FINAL SURFACE ASPHALT.
 - ⑤ FOR REMOVAL OF MEDIAN PAVEMENT THROUGHOUT REHAB SECTION, RELIEF JOINTS, BASE FAILURE REPAIRS AND LOCATIONS OF SPOT PAVEMENT REPLACEMENT. BASE FAILURE AREA ESTIMATED AT 7.5% TOTAL EXISTING CONCRETE PAVEMENT AREA. TOTAL INCLUDES 24891 LF SAWCUT FOR RELIEF JOINTS AND BASE FAILURE REPAIRS.
 - ⑥ FOR JOINT BETWEEN MEDIAN AND DRIVING LANE PAVEMENTS THROUGHOUT REHAB SECTION AND LOCATIONS OF SPOT PAVEMENT REPLACEMENT ESTIMATED AT 75 MGAL PER MILE
 - ⑦ FOR CONTROLLING DUST CAUSED BY MAINTAINING TRAFFIC ONLY; ESTIMATED AT 75 MGAL PER MILE
 - ⑧ EARTHWORK QUANTITIES ARE APPROXIMATE AND FOR INFORMATION ONLY EARTHWORK QUANTITIES:
COMMON 21752 CY
EMBANKMENT 1875 CY
 - ⑨ FOR REMOVAL AT APPROACHES AND ENTRANCES WHERE INDICATED
 - ⑩ TO INCLUDE REMOVAL OF POLES, EQUIPMENT, AND CONCRETE BASES. CONCRETE BASES TO BE REMOVED TO 12 INCHES BELOW EXISTING GROUND LINE. STOP SIGNALS HEADS AND LIGHTER DRIVE AND KY 447 INTERSECTIONS; DELIVER POLES, SIGNAL 310 VALLEY CREEK ROAD ELIZABETHTOWN, KY 42701
 - ⑪ TO BE COORDINATED WITH KYTC DISTRICT 4 TRAFFIC (2701) 401-8132
 - ⑫ TO BE DELIVERED TO THE BAILEY BRIDGE YARD
- ⑬ ALL EXISTING PIPES (INCLUDING COMMERCIAL ENTRANCE PIPES WITHIN R/W) TO BE INSPECTED BEFORE CONSTRUCTION BEGINS WITHIN R/W TO BE CLEANED OR REPAIRED AS DIRECTED BY THE ENGINEER. ALL EXISTING PIPES TO BE CLEANED OR REPAIRED AS DIRECTED BY THE ENGINEER. TOTAL TO EXISTING PIPE CLEAN PIPE STRUCTURE AND PIPE REPAIR EACH ESTIMATED AT 20% OF EXISTING PIPES.
 - ⑭ INCLUDES PAVEMENT RELIEF JOINTS AND BASE FAILURE
 - ⑮ SPREAD ACROSS ALL SECTIONS BUT PAID FOR IN ITEM 4-20011.00
 - ⑯ INCLUDES ALL APPROACH ROADS AND COMMERCIAL ENTRANCES
 - ⑰ 1.5' GUTTER WIDTH
 - ⑱ FOR MAINTENANCE OF TRAFFIC
 - ⑲ LUMP SUM BID ITEMS TO INCLUDE ALL PROJECTS
 - ⑳ FOR WRAPPING PIPE TRENCH BACKFILL
 - ㉑ ALL WORK AND FINAL PEDESTAL LOCATIONS TO BE COORDINATED IN THE FIELD WITH JUSTIN WALLACE KYTC DISTRICT 4 TRAFFIC ENGINEER. COORDINATION SHALL BEGIN PRIOR TO PAVING OPERATIONS TO ENSURE PROPER PLACEMENT OF CONDUIT, JUNCTION BOXES AND PEDESTAL POSTS. SPREAD ACROSS ALL SECTIONS BUT PAID FOR IN ITEM 4-9008.50.
 - ㉒ INCLUDES 1500 TONS FOR PATCHING, AS DIRECTED BY THE ENGINEER.
 - ㉓ MOBILIZATION WILL ONLY BE PAID ONCE, REGARDLESS OF PROJECT PHASING OR PATCHING, AS DIRECTED BY THE ENGINEER.
 - ㉔ FOR PLACEMENT OF 6-INCH CONCRETE CAP OVER GAS LINE IF LESS THAN 30 INCHES OF COVER IS PRESENT TO TOP OF PIPE.

**PAVEMENT REHAB & SAFETY
US 31W
GENERAL SUMMARY**

GENERAL SUMMARY

ITEM	DESCRIPTION	UNIT	4-154.20	4-20011.00	4-9008.50	TOTAL PROJECT
1810	STANDARD CURB AND GUTTER	LF	586	1642	1357	3585
1811	STANDARD CURB AND GUTTER MODIFIED	LF	732	1542	271	2545
1812	REMOVE CURB AND GUTTER	LF	0	202	0	202
1820	LIP CURB AND GUTTER	LF	0	0	57	57
1875	STANDARD HEADER CURB	LF	43	0	203	246
1891	ISLAND HEADER CURB TYPE 2	LF	452	0	241	693
1917	REMOVE CURB	LF	0	0	48	48
1918	STANDARD BARRIER MEDIAN TY 2	SY	0	0	587	587
1921	STANDARD BARRIER MEDIAN TY 4	SY	5997	2424	4756	13177
1992	REINFORCEMENT FOR CURB AND GUTTER	EACH	0	0	19	19
2014	BARRICADE TYPE III	EACH	0	0	208	208
2091	REMOVE PAVEMENT	SY	1796	176	2241	4213
2159	TEMPORARY DITCH	LF	660	200	850	1710
2200	CLEAN TEMPORARY DITCH	LF	330	308	425	855
2203	STRUCTURE EXCAVATION LANGASSIER	CY	4444	12825	4483	21752
2223	GRANULAR EMBANKMENT	CY	14	0	9	23
2237	DITCHING	LF	500	500	500	1500
2242	WATER	M.GAL	0	0	262	262
2351	GUARDRAIL - STEEL W BEAM - SINGLE FACE	LF	0	0	512.5	512.5
2369	GUARDRAIL END TREATMENT TY 2A	EACH	0	0	1	1
2381	REMOVE GUARDRAIL	LF	0	0	201	201
2391	GUARDRAIL END TREATMENT TY 4A	EACH	0	0	1	1
2429	RIGHT-OF-WAY MONUMENT TYPE 1	EACH	2	0	5	7
2432	WITNESS POST	EACH	1	0	2	3
2483	CHANNEL LINING CLASS II	TON	22	27	167	216
2545	CLEARING AND GRUBBING	LS	0	0	1	1
2555	CONCRETE - CLASS B	CY	14.8	0	9.3	24.1
2562	TEMPORARY SIGNS	SF	0	0	1950	1950
2568	MOBILIZATION	LS	0	1	0	1
2569	DEMOBILIZATION	LS	1	1	0	3
2570	PROJECT CPM SCHEDULE	LS	0	0	1	1
2585	EDGE KEY	LF	0	7400	0	7400
2607	FABRIC-GEOTEXTILE CLASS 2 FOR PIPE	SY	4192	881	3452	8525
2611	HANDRAIL - TYPE A-1	LF	67	0	52	119
2650	MAINTAIN AND CONTROL TRAFFIC	LS	0	0	1	1
2671	PORTABLE CHANGEABLE MESSAGE SIGNS	EACH	0	0	6	6
2676	MOBILIZATION FOR MILL & TEXT	LS	0	1	0	1
2677	ASPHALT PAVE MILLING & TEXTURING	TON	0	37629	0	37629
2696	SHOULDER RUMBLE STRIPS	LF	0	0	325	325
2701	TEMPORARY SILT FENCE	LF	660	200	850	1710
2703	SILT TRAP TYPE A	EACH	5	2	4	11
2704	SILT TRAP TYPE B	EACH	5	2	4	11
2705	SILT TRAP TYPE C	EACH	5	2	4	11
2706	CLEAN SILT TRAP TYPE A	EACH	5	2	4	11
2707	CLEAN SILT TRAP TYPE B	EACH	5	2	4	11
2708	CLEAN SILT TRAP TYPE C	EACH	5	2	4	11
2720	SIDEWALK - 4 IN CONCRETE	SY	368	1439	818	2625
2721	REMOVE SIDEWALK	SY	0	0	6	6
2726	STAKING	LS	1	0	0	1
2775	ARROW PANEL	EACH	0	0	4	4
3262	CLEAN PIPE STRUCTURE	EACH	24	6	19	49
4953	TEMP RELOCATION OF SIGNAL HEAD	EACH	0	0	113	113
4960	REMOVE AND REPLACE SIDEWALK	SY	26	0	50	76
5950	EROSION CONTROL BLANKET	SY	1285	427	1215	2927
5952	TEMPORARY MULCH	SY	4700	1500	5250	11450
5953	TEMP SEEDING AND PROTECTION	SY	3450	1100	3900	8450
5963	INITIAL FERTILIZER	TON	0.20	0.06	0.23	0.49
5964	MAINTENANCE FERTILIZER	TON	0.33	0.10	0.38	0.81
5985	SEEDING AND PROTECTION	SY	6300	1900	7300	15500
5992	AGRICULTURAL LIMESTONE	TON	3.9	1.2	4.5	9.6

ITEM	DESCRIPTION	UNIT	4-154.20	4-20011.00	4-9008.50	TOTAL PROJECT
6510	PAVE STRIPING-TEMP PAINT - 4 INCH	LF	0	0	321000	321000
6514	PAVE STRIPING-PERM PAINT - 4 INCH	LF	4012	399	8208	8208
6530	PAVEMENT STRIPING REMOVAL - 4 INCH	LF	119000	41000	82000	242000
6549	PAVE STRIPING-TEMP REM TAPE-B	LF	11478	3990	10911	26379
6550	PAVE STRIPING-TEMP REM TAPE-W	LF	7652	2660	7274	17586
6551	PAVE STRIPING-TEMP REM TAPE-Y	LF	3826	1330	3637	8793
6565	PAVEMENT MARKING - THERMO X-WALK - 6 INCH	LF	914	149	937	2000
6568	PAVEMENT MARKING - THERMO STOP BAR - 24 INCH	LF	659	162	591	1412
6569	PAVEMENT MARKING - THERMO CROSS-HATCH	SF	1035	253	2029	3317
6573	PAVEMENT MARKING - THERMO STRAIGHT ARROW	EACH	0	3	1	4
6574	PAVEMENT MARKING - THERMO CURVE ARROW	EACH	82	20	44	146
6575	PAVEMENT MARKING - THERMO COMB ARROW	EACH	46	8	43	97
6576	PAVE MARKING - THERMO "ONLY"	EACH	2	5	1	8
6578	PAVE MARKING - THERMO MERGE ARROW	EACH	2	0	0	2
6598	PAVEMENT MARKING REMOVAL	SF	1219	529	1499	3247
15094	S MANHOLE ADJUST TO GRADE	EACH	0	2	2	4
16064	G VALVE BOX ADJUST	EACH	0	0	1	1
10020NS	FUEL ADJUSTMENT	DOLLAR	0	129689	0	129689
10030NS	ASPHALT ADJUSTMENT	DOLLAR	0	298998	0	298998
20550ND	SAW CUT PAVEMENT	LF	0	40803	0	40803
20550ND	CONCRETE SIGNAL PEGS	EACH	0	35000	0	35000
22520EN	PAVEMENT MARKING - THERMO YIELD BAR - 36 INCH	LF	24	12	53	89
23158550S	DETECTABLE WARNINGS	SF	213	117	278	608
23274EN1F	TURF REINFORCEMENT MAT 1	SY	0	0	6	6
24489EC	INLAID PAVEMENT MARKERS	EACH	729	170	414	1313
24679ED	PAVE MARK THERMO CHEVRON	SF	2784	1723	2561	7068
24810ED	SIDEWALK FLUME	EACH	0	0	1	1
24955ED	REMOVE SIGNAL EQUIPMENT	EACH	0	0	2	2
23131ER701	PIPELINE VIDEO INSPECTION	LF	14358	3688	10623	28669
23956FC	PIPE REPAIR	EACH	24	6	19	49
24995EC	PAVE STRIPING - SPRAY THERMO - 6 IN W	LF	34956	9383	22697	67636
24996EC	PAVE STRIPING - SPRAY THERMO - 6 IN Y	LF	14398	5196	11738	31332
24768EC	LANE SEPARATOR CURB	LF	0	0	4500	4500
24261EC	ISLAND CURB AND GUTTER (MODIFIED)	LF	0	86	0	86
06544	PAVE STRIPING - THERMO - 8 IN W	LF	0	0	190	190
20314ED	MILLED RUMBLE STRIPS	LF	0	0	190	190
04844	CABLE-NO. 14/5C	LF	0	0	1400	1400
24901EC	PVC CONDUIT-2 IN SCHEDULE 80	LF	0	0	1980	1980
04820	TRENCHING AND BACKFILLING	LF	0	0	990	990
04811	ELECTRICAL JUNCTION BOX TYPE B	EACH	0	0	16	16
20093MS835	INSTALL PEDESTRIAN HEAD - LED	EACH	0	0	15	15
23235EC	INSTALL PEDESTAL POST	EACH	0	0	9	9
20097ES601	CONCRETE CAP	LF	40	0	70	110

- 1 APPROXIMATELY 4 ACRES TOTAL
- 2 FOR RETAINING WALL
- 3 FOR MAINTENANCE OF TRAFFIC
- 4 FOR THE REMOVAL OF ALL STRIPING AND MARKING THAT WILL CONFLICT WITH MAINTENANCE OF TRAFFIC OR FUTURE PROPOSED TRAFFIC PATTERNS AND MARKINGS. NO WATER BLASTING WILL BE PERMITTED ON FINAL SURFACE ASPHALT. TEMPORARY STRIPING IN ITS FINAL LOCATION TO BE REMOVED ON FINAL SURFACE ASPHALT.
- 5 FOR REMOVAL OF MEDIAN PAVEMENT THROUGHOUT REHAB SECTION. RELIEF JOINTS, BASE FAILURE REPAIRS AND LOCATIONS OF SPOT PAVEMENT REPLACEMENT. BASE FAILURE AREA ESTIMATED AT 7.5% TOTAL EXISTING CONCRETE PAVEMENT AREA. TOTAL INCLUDES 24891 LF SAWCUT FOR RELIEF JOINTS AND BASE FAILURE REPAIRS.
- 6 FOR JOINT BETWEEN MEDIAN AND DRIVING LANE PAVEMENTS THROUGHOUT REHAB SECTION AND LOCATIONS OF SPOT PAVEMENT REPLACEMENT.
- 7 FOR CONTROLLING DUST CAUSED BY MAINTAINING TRAFFIC ONLY; EMBANKMENT 21752 CY COMMON 1875 CY
- 8 EARTHWORK QUANTITIES ARE APPROXIMATE AND FOR INFORMATION ONLY EARTHWORK QUANTITIES: COMMON 21752 CY EMBANKMENT 1875 CY
- 9 FOR REMOVAL OF APPROACH ROADS AND COMMERCIAL ENTRANCES.
- 10 TO INCLUDE REMOVAL OF POLES, EQUIPMENT, AND CONCRETE BASES. CONCRETE BASES TO BE REMOVED TO 12 INCHES BELOW EXISTING GROUND LINE; STOP SIGNALS AT STARLITE CENTER DRIVE AND KY 447 INTERSECTIONS. DELIVER POLES, SIGNAL HEADS AND CABINETS TO: 310 VALLEY CREEK ROAD ELIZABETHTOWN, KY 42701
- 11 BEFORE DELIVERING, CONTACT KYTC DISTRICT 4 TRAFFIC: (270) 401-8132
- 12 TO BE COORDINATED WITH KYTC DISTRICT 4 TRAFFIC
- 13 ALL EXISTING PIPES (INCLUDING COMMERCIAL ENTRANCE PIPES WITHIN R/W) TO BE INSPECTED BEFORE CONSTRUCTION BEGINS AND TO BE CLEANED OR REPAIRED AS DIRECTED BY THE ENGINEER. (SEE ALSO NOT NOTES) APPROXIMATELY 22,200 OF INSPECTION TOTAL IS EXISTING PIPE; CLEAN PIPE STRUCTURE AND PIPE REPAIR EACH ESTIMATED AT 20% OF EXISTING PIPES.
- 14 INCLUDES PAVEMENT RELIEF JOINTS AND BASE FAILURE
- 15 SPREAD ACROSS ALL SECTIONS BUT PAID FOR IN ITEM 4-20011.00
- 16 INCLUDES ALL APPROACH ROADS AND COMMERCIAL ENTRANCES
- 17 1.5' GUTTER WIDTH
- 18 FOR MAINTENANCE OF TRAFFIC
- 19 LUMP SUM BID ITEMS TO INCLUDE ALL PROJECTS
- 20 FOR WRAPPING PIPE TRENCH BACKFILL
- 21 ALL WORK AND FINAL PEDESTAL LOCATIONS TO BE COORDINATED IN THE FIELD WITH JUSTIN WALLACE, KYTC DISTRICT 4 TRAFFIC ENGINEER. COORDINATION SHALL BEGIN PRIOR TO PAVING OPERATIONS TO ENSURE PROPER PLACEMENT OF CONDUIT, JUNCTION BOXES AND PEDESTAL POSTS. SPREAD ACROSS ALL SECTIONS BUT PAID FOR IN ITEM 4-9008.50.
- 22 INCLUDES 1500 TONS FOR PATCHING, AS DIRECTED BY THE ENGINEER.
- 23 MOBILIZATION WILL ONLY BE PAID ONCE, REGARDLESS OF PROJECT PHASING OR PATCHING, AS DIRECTED BY THE ENGINEER.
- 24 FOR PLACEMENT OF 6-INCH CONCRETE CAP OVER GAS LINE IF LESS THAN 30 INCHES OF COVER IS PRESENT TO TOP OF PIPE.

PAVEMENT REHAB & SAFETY
US 31W
GENERAL SUMMARY

PAVING AREAS

ITEM	S Q U A R E Y A R D S			TOTAL PROJECT
	4-154.20	4-20011.00	4-9008.50	
1.5" CL 3 ASPHALT SURFACE 0.38A PG 76-22	2471	23141	153745	179357
3.0" CL 3 ASPHALT BASE 1.00D PG 76-22		60195		60195
3.0" CL 3 ASPHALT BASE 1.00D PG 64-22		3890		3890
3.0" CL 3 ASPHALT BASE 1.00D PG 64-22		1926		1926
3.0" CL 3 ASPHALT BASE 1.00D PG 64-22		1926		1926
3.0" CL 3 ASPHALT BASE 1.00D PG 64-22		1926		1926
3.25" CL 3 ASPHALT BASE 1.00D PG 76-22	1783		2852	4635
3.25" CL 3 ASPHALT BASE 1.00D PG 64-22	1783	3505	2852	8140
3.5" CL 3 ASPHALT BASE 1.00D PG 64-22		4066		4066
3.5" CL 3 ASPHALT BASE 1.00D PG 64-22		3422		3422
3.5" CL 3 ASPHALT BASE 1.00D PG 64-22		3422		3422
4.0" CL 3 ASPHALT BASE 1.00D PG76-22		124952	1816	126768
4.0" CL 3 ASPHALT BASE 1.00D PG64-22		10788	1816	12604
4.0" CL 3 ASPHALT BASE 1.00D PG64-22		11301	1816	13117
4.0" CL 3 ASPHALT BASE 1.00D PG64-22		2143		2143
4.0" CL 3 ASPHALT BASE 1.00D PG64-22		1533		1533
4.5" CL 3 ASPHALT BASE 1.00D PG64-22		2036		2036
4.5" CL 3 ASPHALT BASE 1.00D PG64-22		2036		2036
4.5" CL 3 ASPHALT BASE 1.00D PG64-22		2017		2017
CEM CONC ENT PAVEMENT-8 IN		331		331
4.0" DGA		7474	1617	9091
4.0" CSB	2114	2135	4882	9131
8.0" CSB		2603		2603
12" CSB		16303	163	16466
FULL DEPTH DGA		4694	596	5290
GEOCOMPOSITE REINFORCEMENT FOR ASPHALT		10453		10453
LEVELING & WEDGING PG 76-22 (CY BY END AREA METHOD)		4245		4245
ASPHALT SEAL COAT		3295	96	3391
ASPHALT SEAL AGGREGATE		3295	96	3391
ASPHALT MATERIAL FOR TACK NON-TRACKING	4254	239338	11152	254744

PAVING QUANTITIES

ITEM CODE	ITEM	UNIT	4-154.20	4-20011.00	4-9008.50	TOTAL PROJECT
339	CL 3 ASPHALT SURFACE 0.38D PG 64-22 (K)	TON		1500		1500
336	CL 3 ASPHALT SURFACE 0.38A PG 76-22 (J)	TON	204	1909	12684	14797
216	CL 3 ASPHALT BASE 1.00D PG 76-22	TON	319	37422	909	38650
214	CL 3 ASPHALT BASE 1.00D PG 64-22 (G)	TON	319	11497	1310	13126
2101	CEM CONC ENT PAVEMENT-8 IN	SQ YD		331		331
3	CSB (A)	TON	486	14808	1844	17138
1	DGA (I)	TON		1719	281	2000
25010EC	GEOCOMPOSITE REINFORCEMENT FOR ASPHALT (C)	SQ YD		10453		10453
103	ASPHALT SEAL COAT (B)	TON		8	1	9
100	ASPHALT SEAL AGGREGATE (C)	TON		66	2	68
24970EC	ASPHALT MATERIAL FOR TACK NON-TRACKING (D)	TON	2	101	5	108
24785EC	FIBER REINFORCEMENT FOR HMA (F)	TON	523	39331	13593	53447
194	LEVELING & WEDGING PG 76-22 (E)	TON		8405		8405
24781EC	INTELLIGENT COMPACTION FOR ASPHALT	TON	842	59233	14903	74978
24780EC	INTELLIGENT COMPACTION FOR AGGREGATE	TON	486	14808	1844	17138
24891EC	PAVE MOUNT INFRARED TEMP EQUIPMENT	SQ FT	54333	3554874	142380	3751587

ALL ASPHALT MIXTURES ESTIMATED AT 110 LBS. PER SQUARE YARD PER INCH UNLESS NOTED OTHERWISE

- (A) ESTIMATED AT 115 LBS. PER SQUARE PER INCH OF DEPTH; QUANTITIES FOR FULL-DEPTH SHOULDERS CALCULATED BY AVERAGE END AREA METHOD
- (B) ESTIMATED AT 2.40 LBS. PER SQUARE YARD (2 APPLICATIONS)
- (C) ESTIMATED AT 20 LBS. PER SQUARE YARD (2 APPLICATIONS)
- (D) ESTIMATED AT 0.84 LBS. PER SQUARE YARD (BETWEEN ASPHALT PAVEMENT COURSES). TACK RATE TO BE INCREASED FURTHER AS DIRECTED BY THE ENGINEER FROM STA. 1024+38 TO STA. 1029+32 FOR THE TWO NORTHBOUND LANES OVER EXISTING CONCRETE.
- (E) TO INCLUDE QUANTITIES FOR MAKING ADJUSTMENTS TO CROSS SLOPES AND WHERE NEEDED AT TIE-DOWNS; AS DIRECTED BY THE ENGINEER
- (F) MIX 3 OUNCES OF ARAMID FIBERS PER TON OF PG76-22 ASPHALT FOR ENTIRE PROJECT EXCEPT FOR THE TWO NORTHBOUND LANES OVER EXISTING CONCRETE FROM STA. 1024+38 TO STA. 1029+32, WHERE THE APPLICATION RATE WILL BE INCREASED TO 4 OUNCES PER TON OF PG 76-22 ASPHALT.
- (G) ADDITIONAL FULL DEPTH REPAIRS AS DIRECTED BY THE ENGINEER WILL BE PAID FOR AT THE CONTRACT UNIT PRICES FOR ITEMS SHOWN ON FULL DEPTH PAVEMENT REPAIR DETAIL. BASE FAILURE AREA ESTIMATED AT 7.5% TOTAL EXISTING CONCRETE PAVEMENT AREA. TOTALS INCLUDE THE FOLLOWING ESTIMATE OF QUANTITIES FOR RELIEF JOINTS AND BASE FAILURE REPAIRS:
4812 TONS CL 3 ASPHALT BASE 1.00D PG 64-22
4785 TONS CSB
2963 SY GEOCOMPOSITE REINFORCEMENT FOR ASPHALT
- (H) ALL ASPHALT SHALL MEET THE COMPACTION SPECIFICATIONS OUTLINED IN SECTION 400 OF KYTC STANDARD SPECIFICATIONS FOR ROAD AND BRIDGE CONSTRUCTION.
- (I) FOR MAINTENANCE OF TRAFFIC AND NON-DRAINING AREAS, TO BE USED AS DIRECTED BY THE ENGINEER.
- (J) MAINLINE SURFACE COURSE FROM 960+52 TO END OF PROJECT PAID FOR IN ITEM 4-9008.50
- (K) FOR TEMPORARY PATCHING FROM BEGINNING OF PROJECT TO STA. 980+20, AS DIRECTED BY THE ENGINEER.

PAVING AREAS

ITEM	SQUARE YARDS			TOTAL PROJECT
	4-154.20	4-20071.00	4-9008.50	
1.5" CL 3 ASPHALT SURFACE 0.38A PG 76-22	2471	23141	153745	179357
3.0" CL 3 ASPHALT BASE 1.00B PG 76-22		60195		60195
3.0" CL 3 ASPHALT BASE 1.00D PG 64-22		3890		3890
3.0" CL 3 ASPHALT BASE 1.00B PG 64-22		1926		1926
3.0" CL 3 ASPHALT BASE 1.00D PG 64-22		1926		1926
3.0" CL 3 ASPHALT BASE 1.00D PG 64-22		1926		1926
3.25" CL 3 ASPHALT BASE 1.00D PG 76-22	1783	2852		4635
3.25" CL 3 ASPHALT BASE 1.00D PG 64-22	1783	2852		8140
3.5" CL 3 ASPHALT BASE 1.00D PG 64-22		4066		4066
3.5" CL 3 ASPHALT BASE 1.00D PG 64-22		3422		3422
3.5" CL 3 ASPHALT BASE 1.00D PG 64-22		3422		3422
4.0" CL 3 ASPHALT BASE 1.00D PG 76-22	10788	1816		12604
4.0" CL 3 ASPHALT BASE 1.00D PG 64-22	11301	1816		13117
4.0" CL 3 ASPHALT BASE 1.00D PG 64-22	2143			2143
4.0" CL 3 ASPHALT BASE 1.00D PG 64-22	1533			1533
4.5" CL 3 ASPHALT BASE 1.00D PG 64-22	2036			2036
4.5" CL 3 ASPHALT BASE 1.00D PG 64-22	2036			2036
4.5" CL 3 ASPHALT BASE 1.00D PG 64-22	2017			2017
CEM CONCRETE PAVEMENT 8" IN	331			331
4.0" DGA	7474	1617		9091
4.00" CSB	2135	4882		9131
8.0" CSB	2603			2603
12" CSB	16303	163		16466
FULL DEPTH DGA	4594	586		5180
GEOCOMPOSITE REINFORCEMENT FOR ASPHALT LEVELING & WEDGING PG 76-22 (CY BY END AREA METHOD)	10453			10453
ASPHALT SEAL COAT	3295	96		3391
ASPHALT SEAL AGGREGATE	3295	96		3391
ASPHALT MATERIAL FOR TACK NON-TRACKING	4254	239338	11152	254744

PAVING QUANTITIES

ITEM CODE	ITEM	UNIT	4-154.20	4-20071.00	4-9008.50	TOTAL PROJECT
339	CL 3 ASPHALT SURFACE 0.38D PG 64-22 (K)	TON		1500		1500
336	CL 3 ASPHALT SURFACE 0.38A PG 76-22 (J)	TON	204	1909	12684	14797
216	CL 3 ASPHALT BASE 1.00D PG 76-22	TON	319	37422	909	38650
214	CL 3 ASPHALT BASE 1.00D PG 64-22 (C)	TON	319	11497	1310	13126
2101	CEM CONCRETE PAVEMENT 8" IN	SQ YD		331		331
3	CSB (A)	TON	486	14808	1844	17138
1	DGA (B)	TON		1719	281	2000
25010EC	GEOCOMPOSITE REINFORCEMENT FOR ASPHALT (G)	SQ YD		10453		10453
103	ASPHALT SEAL COAT (D)	TON		8	1	9
100	ASPHALT SEAL AGGREGATE (C)	TON		66	2	68
24970EC	ASPHALT MATERIAL FOR TACK NON-TRACKING (I)	TON	2	101	5	108
24785EC	FIBER REINFORCEMENT FOR HMA (F)	TON	523	39331	13593	53447
194	LEVELING & WEDGING PG 76-22 (E)	TON		8405		8405
24781EC	INTELLIGENT COMPACTION FOR ASPHALT	TON	842	59233	14903	74978
24780EC	INTELLIGENT COMPACTION FOR AGGREGATE	TON	486	14808	1844	17138
24991EC	PAVE MOUNT INFRARED TEMP EQUIPMENT	SQ FT	54333	3554874	142380	3751587

ALL ASPHALT MIXTURES ESTIMATED AT 110 LBS. PER SQUARE YARD PER INCH UNLESS NOTED OTHERWISE

- (A) ESTIMATED AT 115 LBS. PER SQUARE PER INCH OF DEPTH; QUANTITIES FOR FULL-DEPTH SHOULDERS CALCULATED BY AVERAGE END AREA METHOD
- (B) ESTIMATED AT 2.40 LBS. PER SQUARE YARD (2 APPLICATIONS)
- (C) ESTIMATED AT 20 LBS. PER SQUARE YARD (2 APPLICATIONS)
- (D) ESTIMATED AT 0.84 LBS. PER SQUARE YARD (BETWEEN ASPHALT PAVEMENT COURSES). TACK RATE TO BE INCREASED FURTHER AS DIRECTED BY THE ENGINEER FROM STA. 1024+38 TO STA. 1029+32 FOR THE TWO NORTHBOUND LANES OVER EXISTING CONCRETE. TO INCLUDE QUANTITIES FOR MAKING ADJUSTMENTS TO CROSS SLOPES AND WHERE NEEDED AT TIE-DOWNS; AS DIRECTED BY THE ENGINEER
- (E) MIX 3 OUNCES OF ARAMID FIBERS PER TON OF PG76-22 ASPHALT FOR ENTIRE PROJECT EXCEPT FOR THE TWO NORTHBOUND LANES OVER EXISTING CONCRETE FROM STA. 1024+38 TO STA. 1029+32, WHERE THE APPLICATION RATE WILL BE INCREASED TO 4 OUNCES PER TON OF PG 76-22 ASPHALT
- (G) ADDITIONAL FULL DEPTH REPAIRS AS DIRECTED BY THE ENGINEER WILL BE PAID FOR AT THE CONTRACT UNIT PRICES FOR ITEMS SHOWN ON FULL DEPTH PAVEMENT REPAIR DETAIL. BASE FAILURE AREA ESTIMATED AT 7.5% TOTAL EXISTING CONCRETE PAVEMENT AREA. TOTALS INCLUDE THE FOLLOWING ESTIMATE OF QUANTITIES FOR RELIEF JOINTS AND BASE FAILURE REPAIRS:
 4812 TONS CL 3 ASPHALT BASE 1.00D PG 64-22
 4785 TONS CSB
 2963 SY GEOCOMPOSITE REINFORCEMENT FOR ASPHALT
- (H) ALL ASPHALT SHALL MEET THE COMPACTION SPECIFICATIONS OUTLINED IN SECTION 400 OF KYTC STANDARD SPECIFICATIONS FOR ROAD AND BRIDGE CONSTRUCTION.
- (I) FOR MAINTENANCE OF TRAFFIC AND NON-DRAINING AREAS, TO BE USED AS DIRECTED BY THE ENGINEER.
- (J) MAINLINE SURFACE COURSE FROM 960+52 TO END OF PROJECT PAID FOR IN ITEM 4-9008.50
- (K) FOR TEMPORARY PATCHING FROM BEGINNING OF PROJECT TO STA. 980+20, AS DIRECTED BY THE ENGINEER.

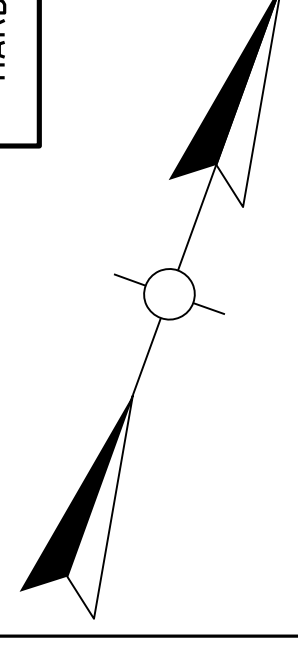

STORM SEWER CHART

STRUC No	LT RT	STATION	OFFSET	DBI CBI JBOX	TYPE	SIZE	THR TG LID	INV	OUTLET PIPE L DIA	CORED HOLE DRAIN BOX CONNECTOR	DOWNSTREAM INLET
181	MED	1085+03.91	(CURB)	CBI	A	4-2	875.97	872.00	147 15		
182	MED	1086+53.91	(CURB)	CBI	A	4-2	872.30	867.65	83 15		
183	MED	1086+53.91	(CURB)	CBI	A	4-2	872.46	867.84	2 15		
184	MED	1087+31.06	(CURB)	CBI	F		870.97	867.00	13 15		
185	RT	1087+38.91	3.00	MH	A		871.14	866.80	56 15		
186	MED	1087+51.01	(CURB)	CBI	A	4-2	870.08	867.00	19 15		

CONSTRUCT STANDARD BARRIER MEDIAN

STATION TO STATION	TYPE	SO. YDS.
1084+00.0 to 1086+66.1	2	206.2
1086+34.0 to 1087+76.1	4	242.0

SLOTTED DRAIN & HEADWALL

INLET STRUC No	STATION	CONNECTING PIPE L DIA	VALLEY CUTTER LENGTH	PIPE OUTLET	
				OF	HEADWALL
185	1087+96.24	866.50	7.40	RT	15" SBO TY 1

(SBO: SLOPED BOX OUTLET)

PAVEMENT REMOVAL CHART

LT-RT OR MED	STATION TO STATION	PAVEMENT REMOVAL SQ. YDS
MED	1089+36.69 to 1091+73.15	213.7

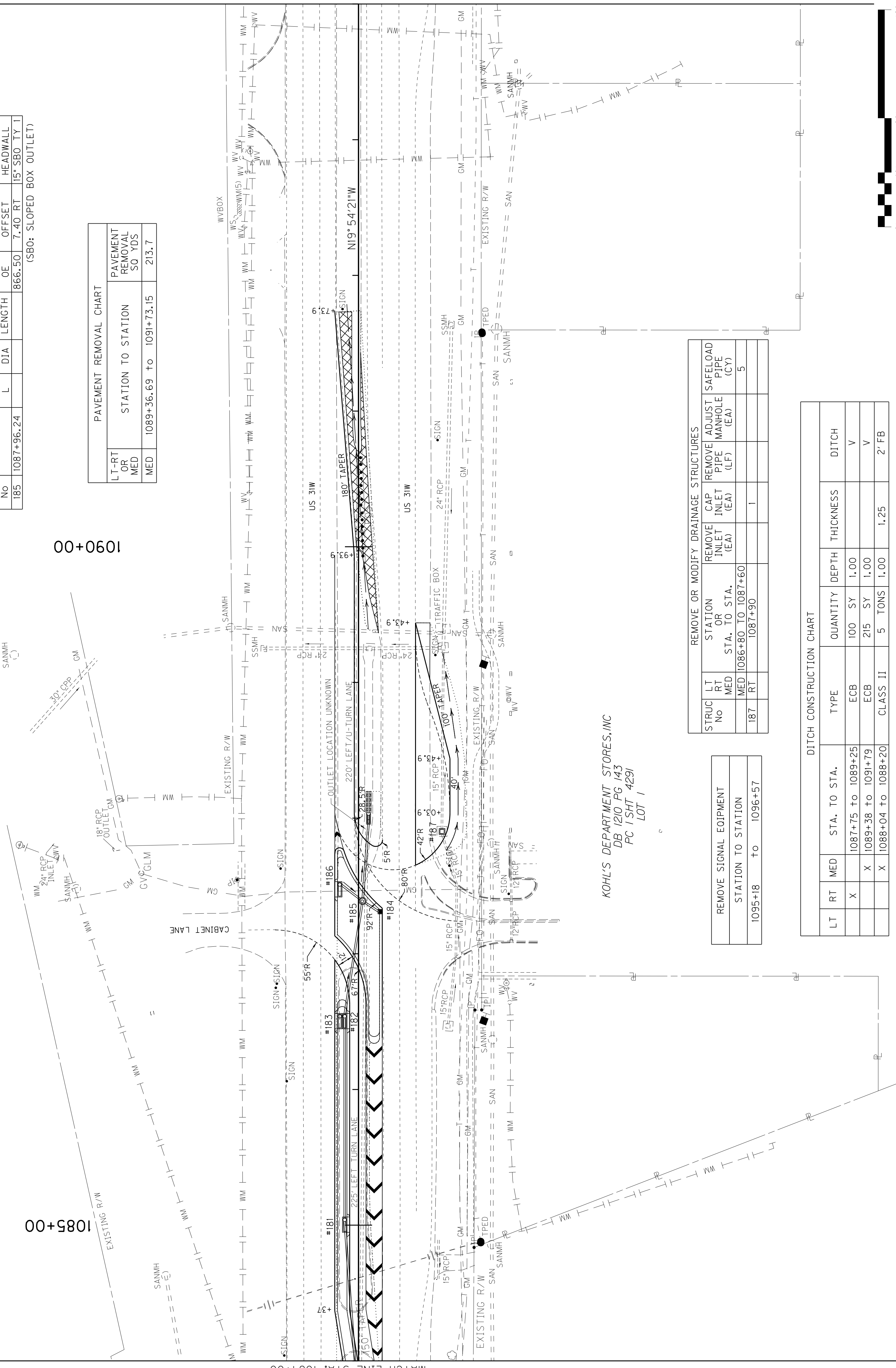

REMOVE OR MODIFY DRAINAGE STRUCTURES

STRUC No	LT RT	STATION OR STA. TO STA.	REMOVE CAP INLET (EA)	ADJUST PIPE (LF)	SAFELOAD MANHOLE (EA)	PIPE (CY)
187	RT	1087+90	1			5

REMOVE SIGNAL EQUIPMENT

STATION TO STATION
1095+18 to 1096+57

DITCH CONSTRUCTION CHART

LT RT	MED	STA. TO STA.	TYPE	QUANTITY	DEPTH	THICKNESS	DITCH
X		1087+75 to 1089+25	ECB	100 SY	1.00		V
	X	1089+38 to 1091+79	ECB	215 SY	1.00		V
	X	1088+04 to 1088+20	CLASS II	5 TONS	1.00	1.25	2' FB

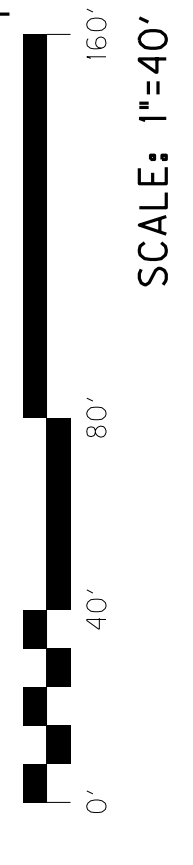

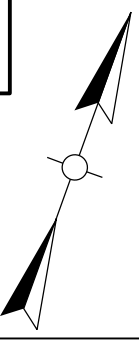

STORM SEWER CHART

STRUC No	LT RT	STATION	OFFSET	DBI CBI JBOX	TYPE	SIZE	THR TG LID	INV	OUTLET PIPE L DIA	CORED HOLE DRAIN BOX CONNECTOR	CAP EXIST. DOWNSTREAM INLET
181	MED	1085+03.91	(CURB)	CBI	A	4-2	875.97	872.00	147	15	
182	MED	1086+53.91	(CURB)	CBI	A	4-2	872.30	867.65	83	15	
183	MED	1086+53.91	(CURB)	CBI	A	4-2	872.46	867.84	2	15	
184	MED	1087+31.06	(CURB)	CBI	F	870.97	867.00	13	15		
185	RT	1087+38.91	3.00	MH	A		871.14	866.80	56	15	
186	MED	1087+51.01	(CURB)	CBI	A	4-2	870.08	867.00	19	15	

CONSTRUCT STANDARD BARRIER MEDIAN

STATION TO STATION	TYPE	SO. YDS.
1084+00.0 to 1086+66.1	2	206.2
1086+34.0 to 1087+76.1	4	242.0

SLOTTED DRAIN & HEADWALL

INLET STRUC No	STATION	CONNECTING PIPE L DIA	VALLEY CUTTER LENGTH	PIPE OFFSET	HEADWALL TY
185	1087+96.24			866.50	7.40 RT 15° SBO TY 1

(SBO: SLOPED BOX OUTLET)

PAVEMENT REMOVAL CHART

LT-RT OR MED	STATION TO STATION	PAVEMENT REMOVAL SQ YDS
MED	1089+36.69 to 1091+73.15	213.7

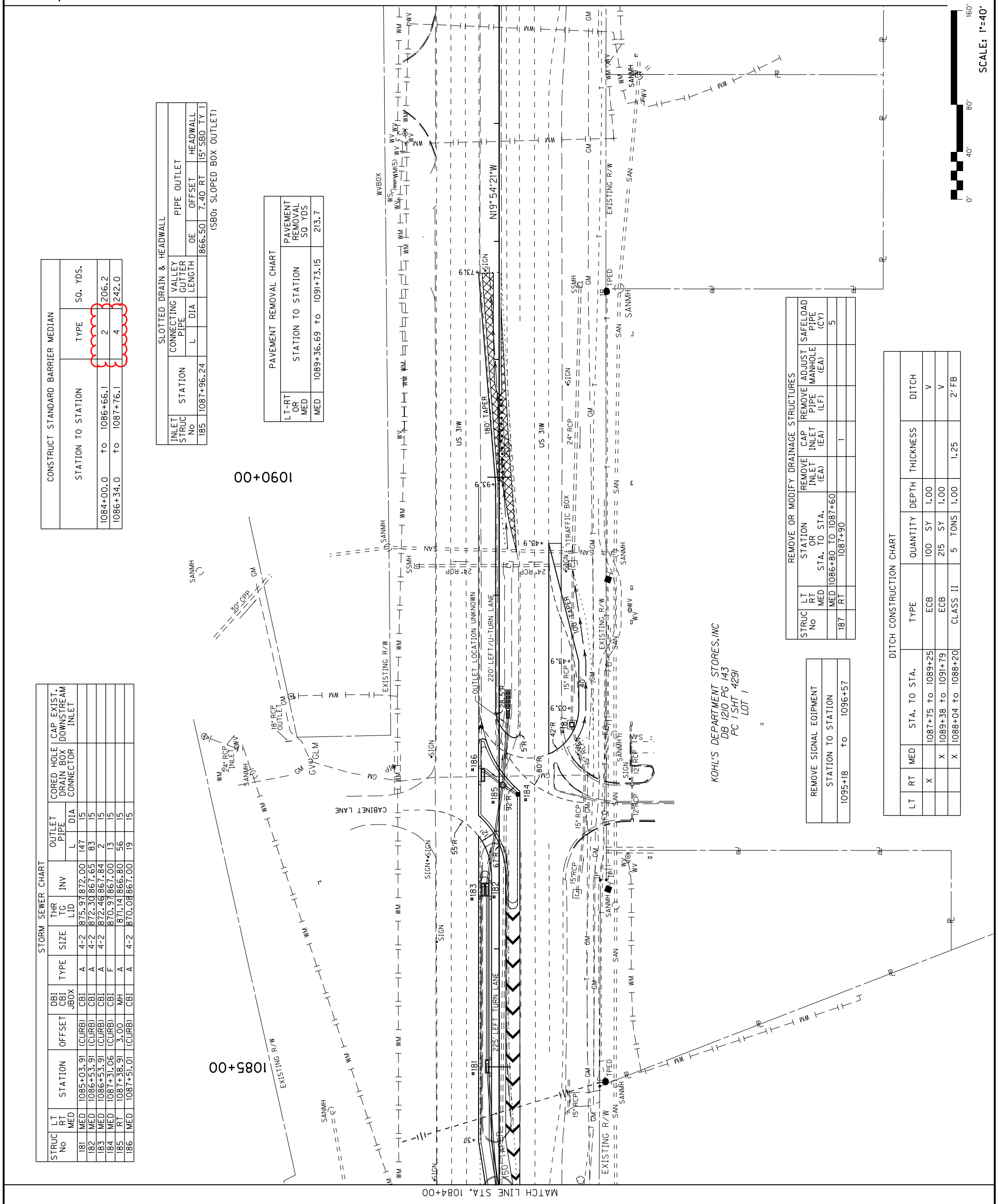

REMOVE OR MODIFY DRAINAGE STRUCTURES

STRUC No	LT RT	STATION OR STA. TO STA.	REMOVE CAP INLET (EA)	ADJUST INLET PIPE (LF)	SAFELOAD MANHOLE (CY)
187	RT	1087+80 TO 1087+60			5
		1087+90	1		

REMOVE SIGNAL EQUIPMENT

STATION TO STATION
1095+18 to 1096+57

DITCH CONSTRUCTION CHART

LT RT	MED	STA. TO STA.	TYPE	QUANTITY	DEPTH	THICKNESS	DITCH
X		1087+75 to 1089+25	ECB	100 SY	1.00		V
	X	1089+38 to 1091+79	ECB	215 SY	1.00		V
	X	1088+04 to 1088+20	CLASS II	5 TONS	1.00	1.25	2' FB

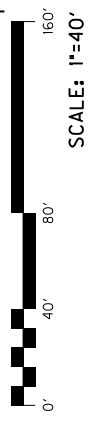

COUNTY OF	ITEM NO.	SHEET NO.
HARDIN	4-154.20	X66

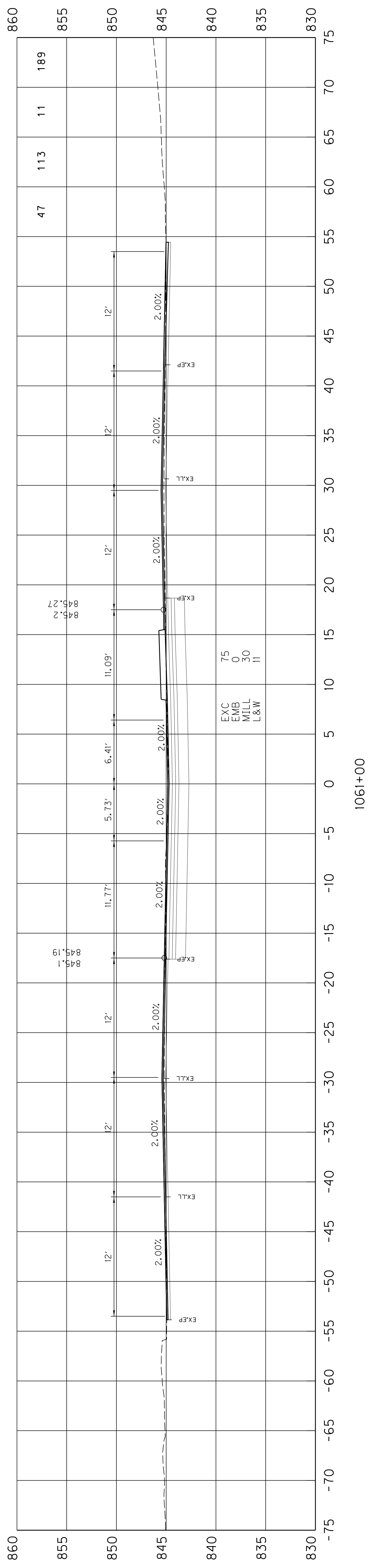
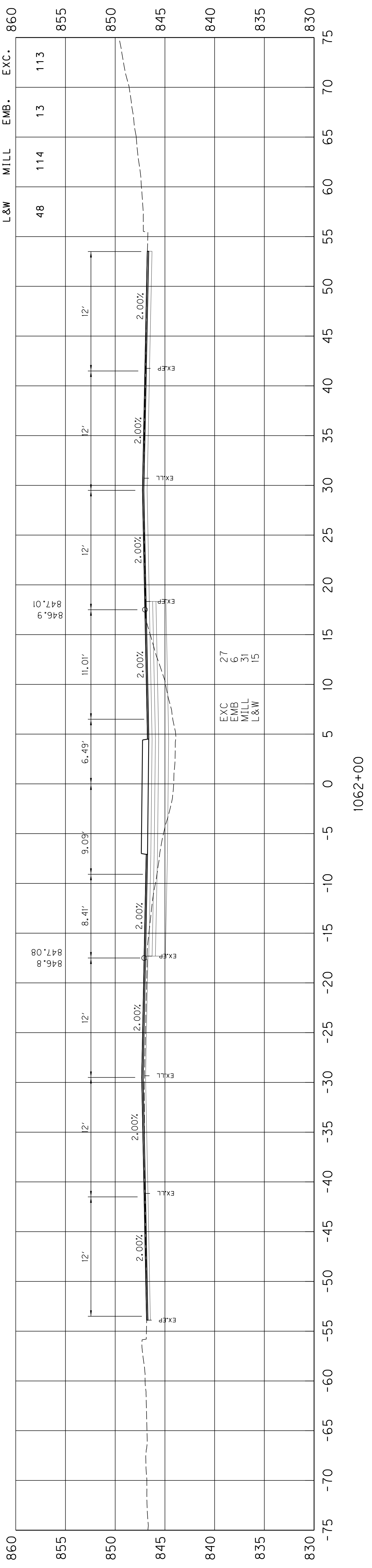

COUNTY OF	ITEM NO.	SHEET NO.
HARDIN	4-154.20	X66

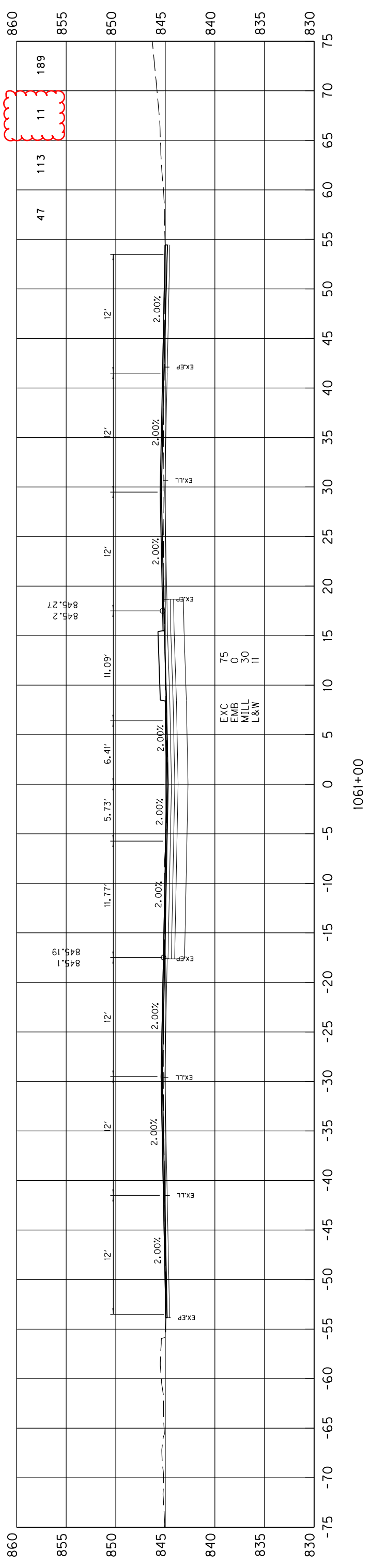
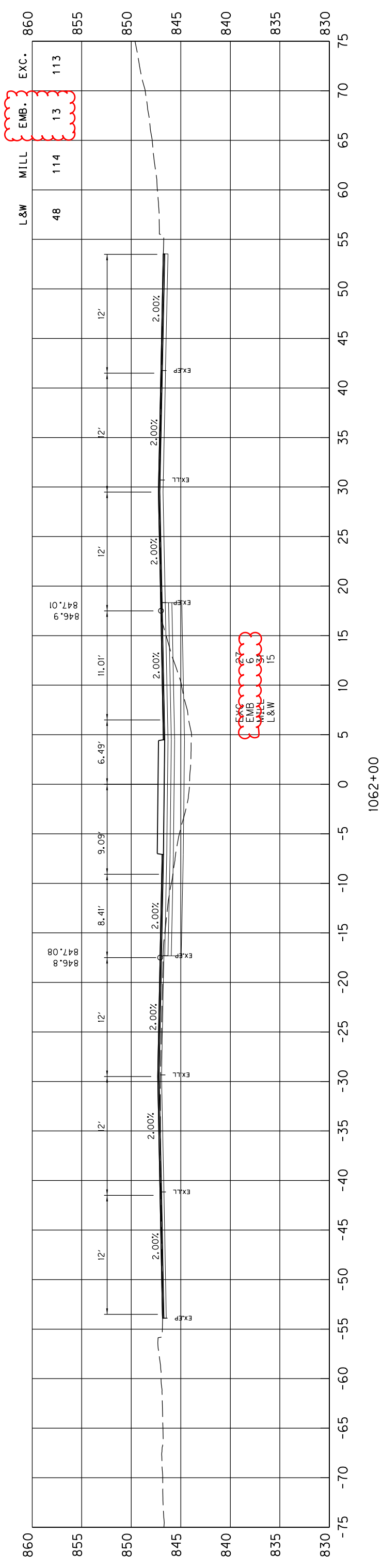

FILE NAME: C:\PW\WORKDIR\PEMIN\ANTHONY-D\MS76020\5 SCALE CROSS SECTIONS RING TO KY47.DGN

USER: anthony-d
DATE PLOTTED: August 18, 2020

E-SHEET NAME:

Power InRoads v8.11.9.397

SCALE: 1"=5'

PAVEMENT REHAB & SAFETY
STA. 1061+00 TO STA. 1062+00
CROSS SECTION SHEET

COUNTY OF	ITEM NO.	SHEET NO.
HARDIN	4-154.20	X67

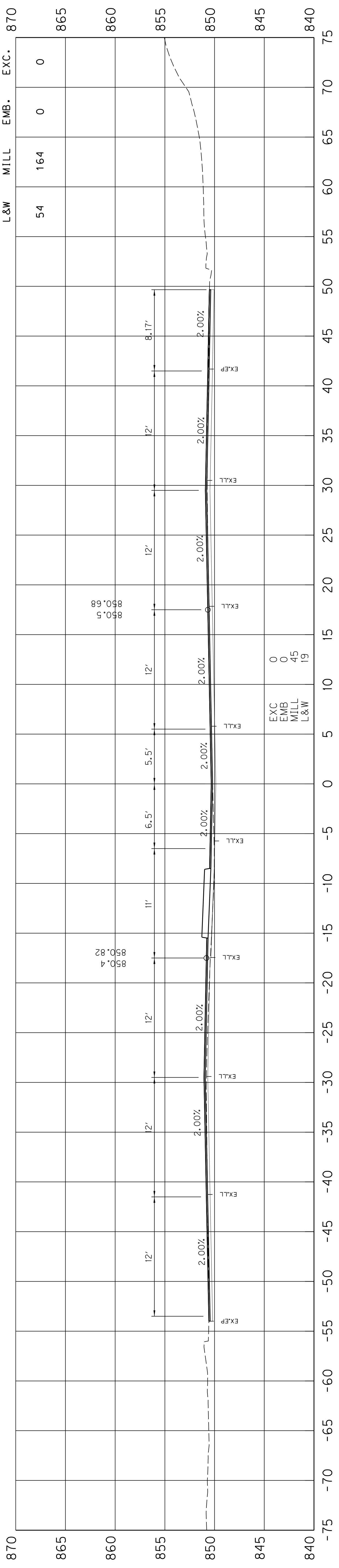

1064+00

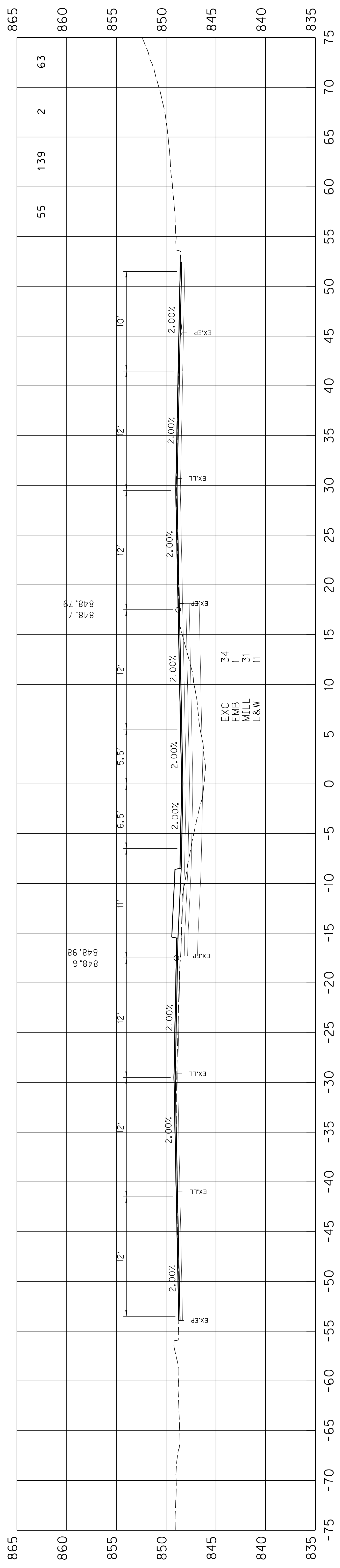

1063+00

FILE NAME: C:\PW-WORKDIR\PEWIN-ANTHONY-D\MS7620\5 SCALE CROSS SECTIONS RING TO KY447.DGN

DATE PLOTTED: August 18, 2020

E-SHEET NAME: Power InRoads v8.11.9.397

PAVEMENT REHAB & SAFETY
STA. 1063+00 TO STA. 1064+00
CROSS SECTION SHEET

SCALE: 1"=5'

COUNTY OF	ITEM NO.	SHEET NO.
HARDIN	4-154.20	X67

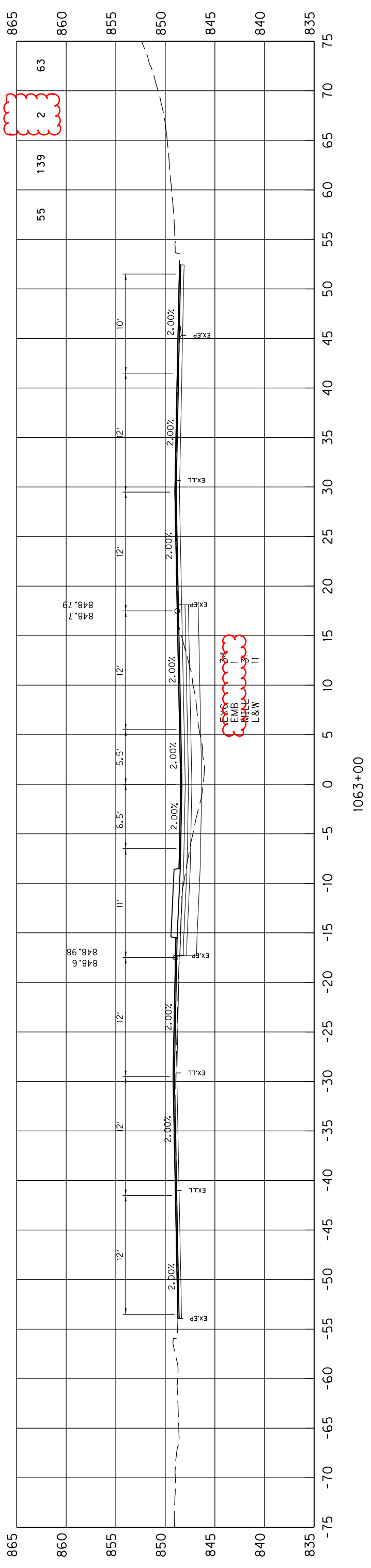
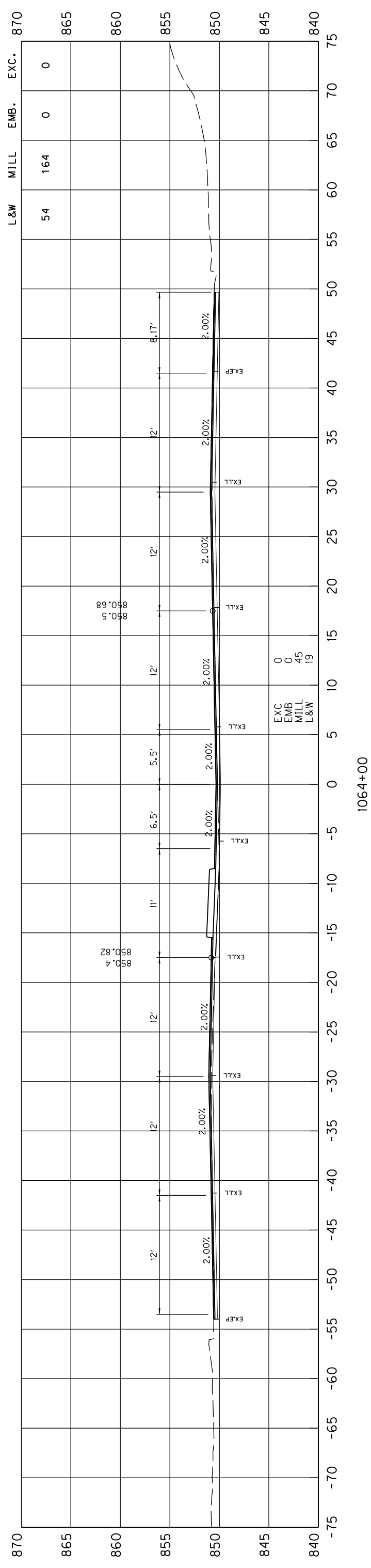

FILE NAME: C:\PW\WORKDIR\PEWIN\ANTHONY-D\MS760205 SCALE CROSS SECTIONS RING TO KY47.DGN

USER: anthony-d
DATE PLOTTED: August 18, 2020

E-SHEET NAME:

Power InRoads v8.11.9.397

PAVEMENT REHAB & SAFETY
STA. 1063+00 TO STA. 1064+00
CROSS SECTION SHEET

SCALE: 1"=5'